



CHANNELL PRODUCT OVERVIEW

May 2020



Distributor:

LAN Cabling Products Ltd- New Zealand
22D Industry Road, Penrose, Auckland, New Zealand 1061
PH: +649 579 9766, Sales@lcp.co.nz

LAN Cabling Products Fiji PTE Ltd
5 Holland Street, Suva, Fiji Island
PH: +679 3384778, LCP@Connect.com.fj

WWW.LCP.CO.NZ

WWW.LCP.CO.NZ

Contents

1 Channell Corporation	4
2 Product Set	5
3 Copper Products	6
3.1 Mini-Rocker Blocks	6
3.2 Customer Termination Boxes (CTB) & Universal Distribution Boxes (UDB)	8
3.3 Rocker Block External Termination Boxes (ETB)	9
3.4 Heat-Shrinkable Wraparound Closure	10
3.5 Copper Heat-Shrinkable Openable Joint Closure	12
3.6 Aerial Heat-Shrinkable Openable Joint Closure	16
3.7 Underground Power Isolation Closures (UPIC)	18
4 Handholes Products	21
4.1 GLB series handholes	21
5 Slam Lock Products	23
5.1 Slam Lock series handholes	23
6 Vault / Pit Products	24
6.1 CHANNELL BULK SERIES PITS.....	27
6.1.1 BULK0 Series Pits (1212)	28
6.1.2 BULK1 Series Pits (1118)	29
6.1.3 BULK2 Series Pits (1324)	30
6.1.4 BULK3 Series Pits (1730)	31
6.1.5 BULK4 Series Pits (2436)	32
6.1.6 BULK5 Series Pits (2448)	33
6.1.7 BULK7 Series Pits (3048)	34
6.1.8 BULK8 Series Pits (3660)	35
6.1.9 BULK9 Series Pits (3676)	36
6.1.10 BULK Accessories	37
6.1.11 BULK Series Rapid Locate System for Shield Cover set.	40

7 Fibre Products	42
7.1 Fibre Dome Closure Series - Heat-Shrinkable	42
7.1.1 14000 Series closures	43
7.1.2 15000 Series closures	45
7.2 Fibre Dome Closure Series – Grommet Technology	48
7.2.1 Lubricated Grommet Technology	48
7.2.2 G4 Series closures	50
7.2.3 G5 Series closures	53
7.2.4 G6 Series closures	57
7.2.5 G9 Series closures	60
7.2.6 G9 Fibre Hub closures	65
7.3 Fibre Inline Closures	67
8 Integrated Fibre Closure Products	69
9 Fibre Hub Products	72
9.1 Optimus Pole / Wall mount Cross Connect Cabinet	73
9.2 Optimus Vault / Pad mount Cross Connect Cabinet	74
10 Pedestal Products	75
10.1 Pedestal Products - Generic	76
10.2 Pedestal Optimus Fibre Products	80
10.2.1 Fibre Pedestals for Air Blown Fibre Applications - OR912 Series	80
10.2.2 Fibre Pedestals for Air Blown Fibre Applications - OR414 Series	81
10.2.3 Fibre Pedestals for Active Equipment Applications - OP1230 series.....	82
10.3 Integrated Optimus Fibre Pedestal	83
10.4 Integrated Flash Fibre Pedestal	84
11 Cabinet Products	86
11.1 Integrated Cabinet	86
12 Cabinet Security Locks	87

1 Channell Corporation

Channell Commercial Corp., is a fourth generation US based company which prides itself as an innovator in design and manufacturing of Outside Plant equipment for the telecommunication, broadband, power, ICT roads, water, rail, mining and cable TV industries. Established in California in 1922 Channell clients are in diverse industries and span the globe. Wherever and whenever buried or aerial cabling infrastructure is required, Channell is there.

Channell is an ISO 9002 certified company headquartered in USA with manufacturing, regional warehousing and sales located across the globe including, California, Texas, Canada, UK, Indonesia, Malaysia, Mexico, and Australia

Channell is a major industry provider of advanced copper connectivity, termination, & distribution products, fibre connectivity & management systems, heat shrink products as well as thermoplastic boxes, pedestals, and cable vaults for above and below ground applications.

Channell products provide piece of mind with secure and robust enclosures, chambers/handholes and housings ensuring the reliability and protection for the most vulnerable points in the underground cable network.

Channel's extensive client list spans decades of service to the Telco/Broadband and Utility industries supplying such companies as;

- | | | | |
|--------------------|--------------------|-----------------|------------------|
| • Verizon | • AT&T | • Comcast | • Time Warner |
| • Cox and Charter | • Singtel | • Liquid | • France Telecom |
| • Malaysia Telecom | • BT | • Bell | • Telmex |
| • Telkom Indonesia | • Optus | • Chorus, | • Telstra |
| • QLD Main Roads | • Brisbane Airport | • Perth Airport | • SA Power |
| • Dubai Airport | • WA Roads | • Meralco | • Energex |



[illegible]

3 Copper Products

3.1 Mini-Rocker Blocks

The 10-Pair Mini-Rocker Modules provide a modular system for sealed IDC termination of multiple copper pairs. The symmetrical mounting design, dual-colored tip/ring identifiers and double-sided access of the module provide quick, craft-friendly installation and maintenance of terminations. A selection of stainless steel and thermoplastic back mount frames is available to accommodate pair counts ranging from 10 to 400.

Features:

- Insulation Displacement Contacts (IDC) eliminates the need to strip wires, resulting in faster in-site connections.
- Hinged wire-entry ports pivot clear of adjacent latches and installed jumpers, allowing easy wire insertion.
- Transparent wire receivers allow visual confirmation of proper wire insertion and IDC contact.
- Tool-less operation: finger-operated receivers and audible latch-down action eliminate problems of breakage through improper use of tools
- High Viscosity Compound (HVC) environmental encapsulation eliminates corrosion enabling mini-rocker to function underwater in high-humidity environments.
- Mini-Rockers stay latched when connections are made, ensuring wire retention and pullout resistance during jumper wire tracing.
- “Quiet front” design and easy test access eliminate shorts and need for disconnection during circuit testing.
- Mini-Rockers will accommodate most wire designs with conductor sizes between 26 AWG - 22 AWG (0.4mm - 0.63mm).

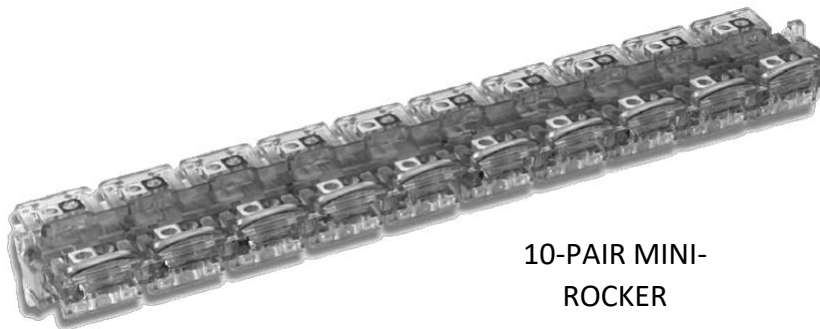

10-PAIR MINI-
ROCKER

10-Pair Mini Rocker Module

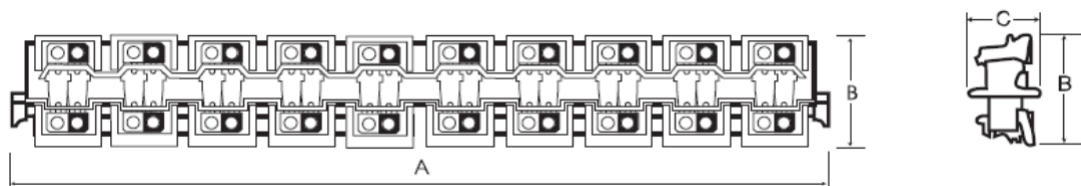

Dimensions

Size	A	B	C
10pr	170 mm	28.5 mm	15.9 mm

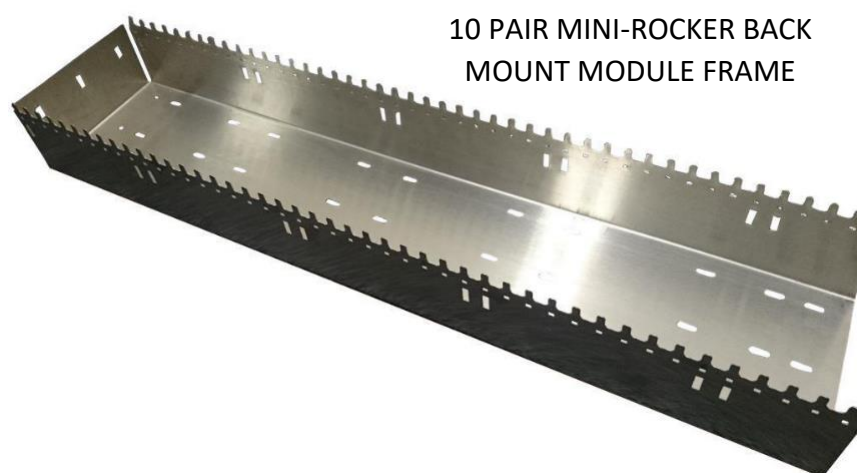

10 PAIR MINI-ROCKER BACK
MOUNT MODULE FRAME

Product Code	Description
MRM10M02T02A01	Channell Minirocker 10 Pair Module - Blue Release - Box of 10
MRM10M02T02A02	Channell Minirocker 10 Pair Module - Green Release - Box of 10

3.2 Customer Termination Boxes (CTB) & Universal Distribution Boxes (UDB)

The Channell thermoplastic wall-mount termination boxes supports the Channell Mini-Rocker 10-Pair sealed IDC connectors with environmentally sealed connection points.

CTB pair count configurations are available for 20 pairs. The UDB50 accommodates up to 50 pairs, and the UDB100 accommodates up to 100 pairs

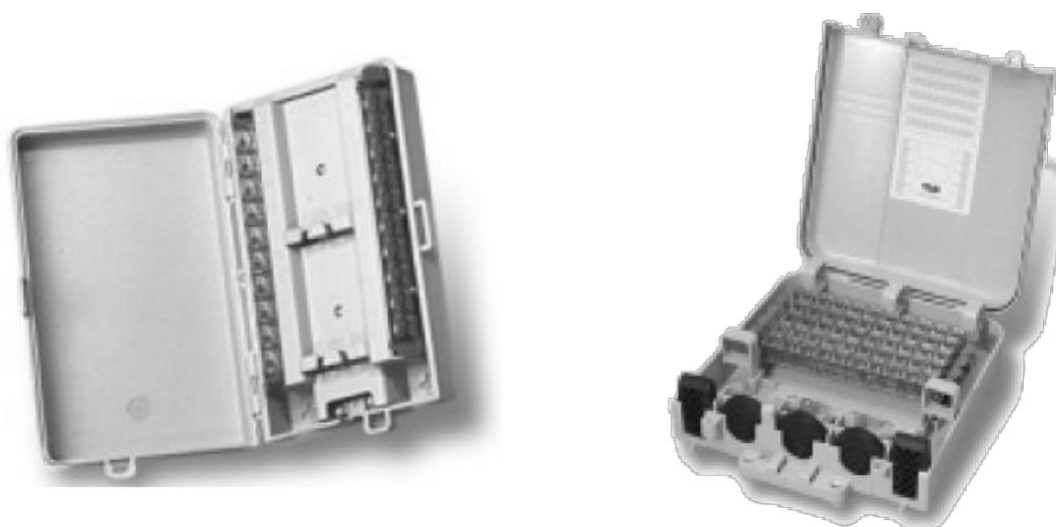

Dimensions

Description	Length	Width	Depth
CTB20	235 mm	155 mm	57 mm
UDB50	263 mm	220 mm	83 mm
UDB100	414 mm	289 mm	96 mm

PRODUCT CODES - CHANNELL Rocker Block External Termination Boxes (ETB)

Product Code	Description
130036	Channell CTB20 Box c/w 2 x 10 Pair Minirockers
130051	Channell UDB50 Box c/w 3 x 10 Pair Minirockers & Bungs (Grey)
140046	Channell UDB100 Box with Entry Bungs (Grey)

3.3 Rocker Block External Termination Boxes (ETB)

Channell Rocker Block External Termination Boxes provide a quick, convenient and reliable method of joining Copper cable pairs

- UV Stabilized Thermoplastic materials
- Rugged, heavy-duty & Impact Resistant
- Corrosion-Proof
- Fast Action terminating Screws
- Easy to install, suitable for walls, wooden, steel or concrete poles
- Easy circuiting with Test Probe 48A



Copper Wire Range

Conductor Size:

- 0.5mm Ø min.
- 1.2mm Ø max.

Insulation Size:

- 1.0mm Ø min.
- 5.0mm Ø max.

Box Size	10 Pair	20 Pair
Depth	63 mm	63 mm
Width	150 mm	170 mm
Height	205 mm	331 mm
Max cable Ø's	11 mm	16 mm

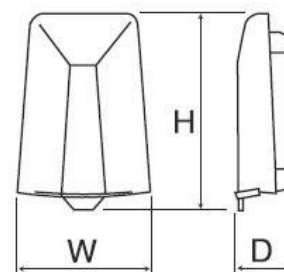

PRODUCT CODES - CHANNELL Rocker Block External Termination Boxes (ETB)

Product Code	Description
RBS1036	Rocker Block 10pr OSW (Ruggedised Terminal Block)
RBS2036	Rocker Block 20pr OSW (Ruggedised Terminal Block)

3.4 Heat-Shrinkable Wraparound Closure

The Channell RSBJ closure is an economic, field proven, fibre reinforced heat-shrinkable wraparound closure system for junction, primary & secondary cable networks.

RSBJ kits comprise a high performance, fibre reinforced heat-shrinkable sleeve, stainless steel channel with clip, aluminium canister, branch clips and all accessories required for installation.



Easy & quick to install

- Aluminium & glass composite structure gives excellent split resistance
- Good performance under high mechanical pressure
- Tough, abrasion, split & UV resistant material
- Strong shrinkage & weather disturbance resistance
- Inner layer of strong hot-melt adhesive to ensure highly effective adhesion to cable
- Consistently good tightness under high & low temperatures
- Suitable for aerial, buried or ducted applications
- Temperature range -400C to 800C
- Thermochromatic paint ensures proper installation

PRODUCT CODES - CHANNELL Heat-Shrinkable Wraparound Closure

Channell part number	Description	Max Joint Dia mm	Min Joint Dia mm	Max Sheathing mm
HSW1	TSF1 42/8-225 CLOSURE HEAT SHRINK 50 PAIR WRAP AROUND BRANCH	42	8	225
HSW1-R	RSBJ-F 43/8-300 REINFORCED CLOSURE WRAPAROUND RSBj-F 75/15-250 REINFORCED	43	8	300
HSW2	TSF2 42/8-350 CLOSURE HEAT SHRINK 100 PAIR WRAP AROUND BRANCH	42	8	350
HSW2-R	RSBJ-F 75/15-250 REINFORCED CLOSURE WRAPAROUND RSBj-F 75/15-350 REINFORCED	43	8	250
HSW3	TSF3 62/22-350 CLOSURE HEAT SHRINK 200-400 PAIR WRAP AROUND BRANCH	62	22	350
HSW3-R	RSBJ-F 75/15-350 REINFORCED CLOSURE WRAPAROUND RSBj-F 75/15-500 REINFORCED	75	15	350
HSW4	TSF4 90/30-500 CLOSURE WRAPAROUND RSBAQF 62/15-500 PRESSURISED	90	30	500
HSW4-R	RSBJ-F 75/15-500 REINFORCED CLOSURE HEAT SHRINK 800 PAIR WRAP AROUND BRANCH	75	15	500
HSW4-RP	RSBAQF 62/15-500 PRESSURISED CLOSURE WRAPAROUND RSBj-F 92/30-500 REINFORCED	62	15	500
HSW5	TSF5 90/30-500 CLOSURE WRAPAROUND RSBAQF 92/25-500 PRESSURISED	122	38	500
HSW5-R	RSBJ-F 92/30-500 REINFORCED CLOSURE HEAT SHRINK 1200 PAIR WRAP AROUND BRANCH	92	30	500
HSW5-RP	RSBAQF 92/25-500 PRESSURISED CLOSURE WRAPAROUND 122/30-500 REINFORCED	92	25	500
HSW6	TSF6 160/42-500 CLOSURE WRAPAROUND RSBAQF 122/30-500 PRESSURISED	160	42	500
HSW6-R	RSBJ-F 122/30-500 REINFORCED CLOSURE WRAPAROUND RSBAQF 122/38-650 PRESSURISED	122	30	500
HSW6-RP-650	RSBJ 122/38 – 650 PRESSURISED CLOSURE WRAPAROUND RSBj-FP 160/55-650 PRESSURISED	122	38	650
HSW7-R	RSBJ 160/42 – 500 REINFORCED CLOSURE WRAPAROUND RSBj-FP 200/65-720 PRESSURISED	160	42	500
HSW7-RP	RSBJ 160/42 – 500 PRESSURISED CLOSURE HEAT SHRINK 50 PAIR WRAP AROUND BRANCH	160	42	500
HSW8-RP	RSBJ 200/65 – 720 PRESSURISED CLOSURE WRAPAROUND RSBj-F 75/15-250 REINFORCED	200	65	720

3.5 Copper Heat-Shrinkable Openable Joint Closure

The Channell Openable Joint Closures utilise proven heat-shrink technology to seal cables into the base. These closures support

- Large oval port to accommodate looped cables
- All auxiliary ports are sealed with easy knockouts
- These closures are re-enterable without the need of special tools
- Weatherproof (IP68), insect proof & UV resistant

These closures are recommended for use underground in manholes or joint boxes, or overhead applications on poles or walls.



Openable Joint, Lockable Small – OJ30



Openable Joint, Lockable Large – OJ31



Openable Joint, Lockable Large – OJ32

OJ30

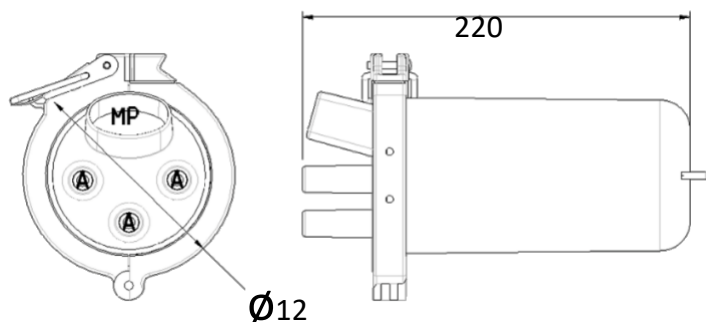

OJ30 – Up to 50 pairs
Main Port (loop)
entry cable Ø

- 1x 10 - 20mm
- 2x 8 - 16mm

A port cable Ø

- 1x 5 - 14mm

OJ31

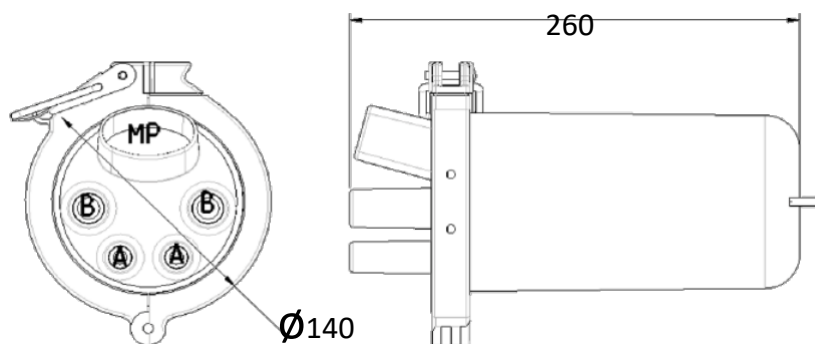

OJ31 – Up to 100 pairs
Main Port (loop) entry
cable Ø

- 1x 22 - 25mm
- 2x 8 - 22mm

A port cable Ø

- 1x 5 - 14mm

B port cable Ø

- 1x 5 - 16mm

OJ32

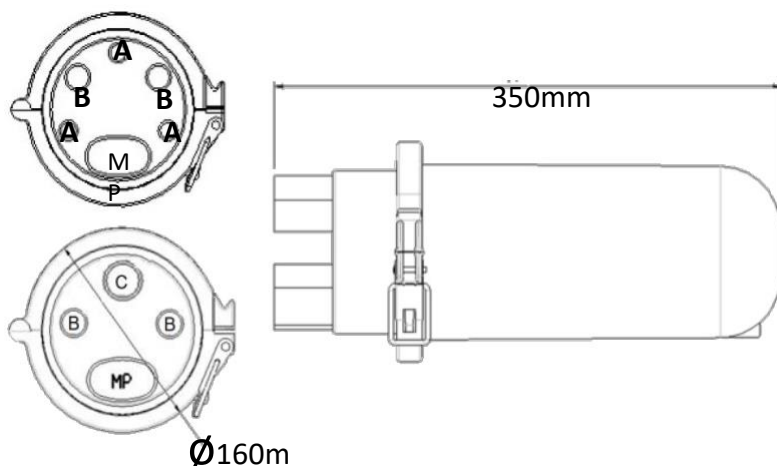

OJ32 – Up to 400 pairs
Main Port (loop) entry
cable Ø

- 1x 30 - 50mm
- 2x 17 - 42mm

A port cable Ø

- 1x 6 - 13mm

B port cable Ø

- 1x 6 - 16mm

C port cable Ø

- 1x 10 - 35mm

EXPLODED VIEW

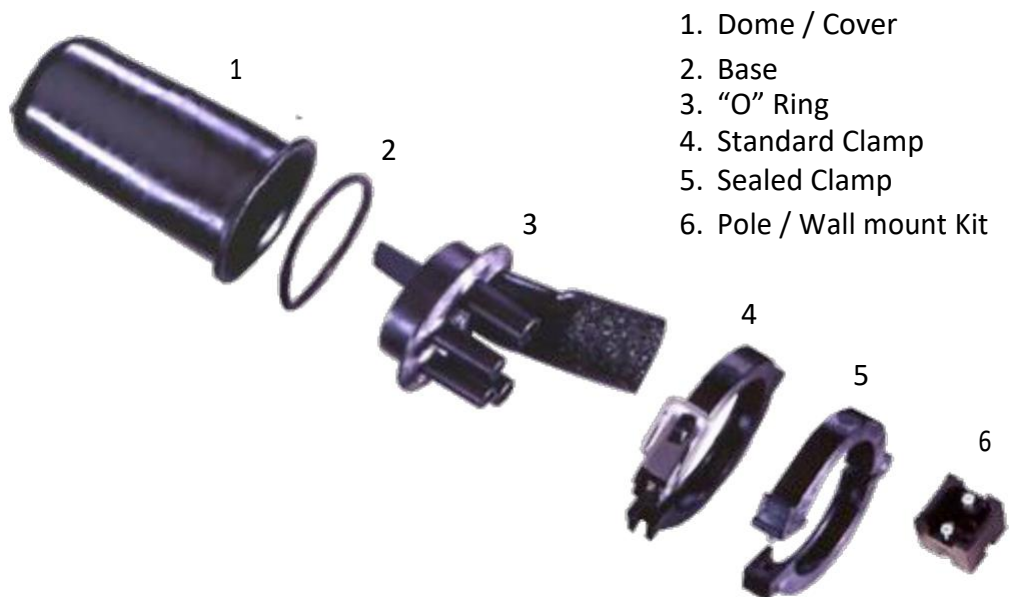

PRODUCT CODES - CHANNELL Heat-Shrinkable Openable Joint Closure

Product Code	Description	Joint Size (copper pair)
130002	Channell OJ30 Closure Standard Dome Lid - Standard Clamp	50 PR
140012	Channell OJ31 Closure - Standard Lid, Standard Clamp	100 PR
140058	Channell OJ31 Closure Long Dome Lid - Standard Clamp	100 PR
150030	Channell OJ32 Closure Standard Dome Lid - Standard Clamp	400 PR
150031	Channell OJ32 Closure Long Dome Lid - Standard Clamp	400 PR

OJ30 Accessories

Product Code	Description
180022	Channell Auxiliary Port Heatshrink Kit - Bag of 10
180073	Maintenance Kit, Main Port, 30 Series (pkt 3)
180062	Channell Pole/Wall Mount Bracket Kit (30/31 Series)
180032	Channell Tape Mastic 25mm x 5m (Sealant Tape)
190079	Channell 30 Series "O" Ring

OJ31 Accessories

Product Code	Description
180022	Channell Auxiliary Port Heat-shrink Kit - Bag of 10
180074	Channell 31 Series Oval Port H/S Kit (Pack of 3)
180062	Mounting Kit – Pole/Wall, 30/31 Series
180032	Mastic Sealant – 25mm x 5m roll, grey
190081	Channell OJ31 Series "O" Ring - 10 per bag

OJ32 Accessories

Product Code	Description
180019	Channell 32 Series Oval Port H/S Kit c/w Glueblock
180042	Channell 32 Series Pole/Wall Mount Bracket Kit
180032	Mastic Sealant – 25mm x 5m roll, grey
190082	Channell 32 Series "O" Ring

Packing Details

Qty per Carton	Carton Size	Carton wgt	Qty per Pallet	Pallet Size	Pallet wgt
OJ30 - 10	34 x 38 x 47 cm	7.5 kg	150	117 x 117 x 97 cm	128 kg
OJ31 - 8	34 x 38 x 47 cm	8 kg	120	117 x 117 x 97 cm	135 kg
OJ32 - 18	115 x 55 x 56 cm	8 kg	72	117 x 117 x 132 cm	135 kg

3.6 Aerial Heat-Shrinkable Openable Joint Closure

The Channell Aerial Openable Joint weatherproof closure (31D) is a re-enterable ready access closure suitable for distribution of aerial copper. The unique looping feature of the 31D closure allows uninterrupted cable runs to be spliced to branch cables or terminated as subscriber drop wires from the one convenient location. The 31D closure can accommodate up to 100 pair of jointed copper cable.

- Weatherproof and insect proof
- Robust construction
- UV resistant
- No heat required for sealing cables
- Main cable can be looped through removable inserts
- Re-entry is achieved without the need of special tools
- Multiple port entry configuration
- Suitable for pole or wall mounting (not underground)
- Available with lockable/re-openable sealing clamp

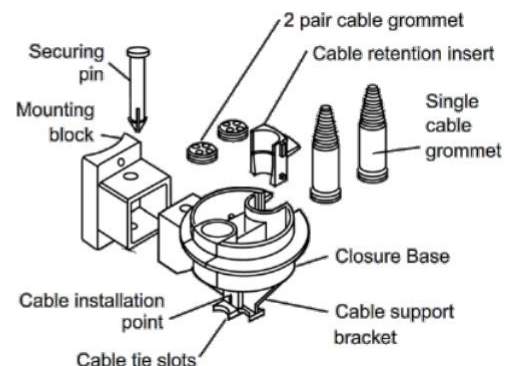
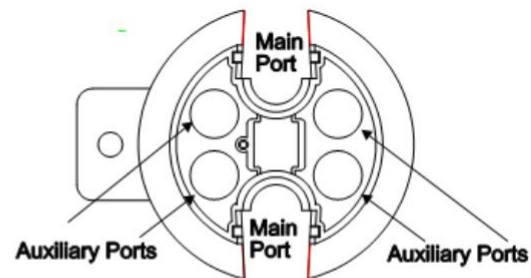

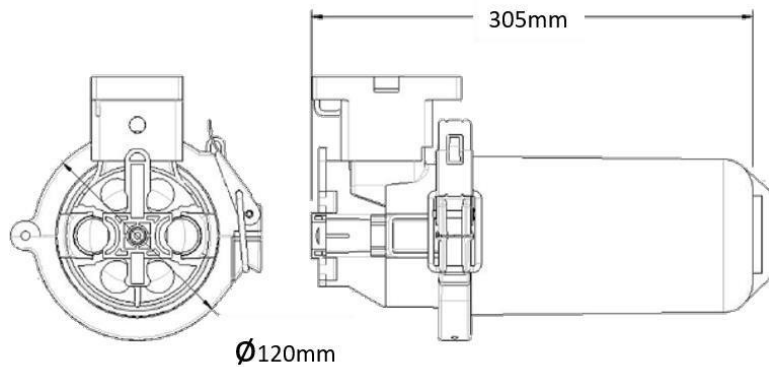

OJ31D – Up to 100 pairs
Main Port (loop) entry cable

Ø

• 1x 8 - 22mm

Single Entry Grommet port
cable Ø

• 1x 5 - 15mm

Dropwire Grommet entry
port cable Ø

• 1x 4mm / 4x 6mm

PRODUCT CODES - CHANNELL Aerial Heat-Shrinkable Openable Joint Closure

Product Code	Description	Joint Size (copper pair)
140038	Channell OJ31d Aerial Closure Standard Dome Lid - Standard Clamp	100 PR

OJ31D Accessories

Product Code	Description
180096	Maintenance Kit, 31D Series,

Packing Details

Qty per Carton	Carton Size	Carton wgt	Qty per Pallet	Pallet Size	Pallet wgt
OJ31D - 8	34 x 38 x 47 cm	8.5 kg	120	117 x 117 x 97 cm	142 kg

3.7 Underground Power Isolation Closures (UPIC)

The 31 & 32 Series UPIC enclosure offers an ideal solution for isolating low voltage underground network services in applications where pit or manhole installation is required.

This fully submersible, re-openable enclosure is perfect for the ever-increasing requirements to house HRC devices, links, fuses and PCB's in underground electrical networks.



31 Series UPIC



32 Series UPIC

Features:

- Designed to meet the harshest of climatic conditions
- Enclosure rated IP68
- Re-enterable enclosure that utilises proven heat-shrink and mastic seal technology to seal cables
- All base ports are sealed until required – easy knockouts
- Re-entry is achieved without the need of special tools
- Multiple port entry configuration
- Suitable for pit installation or direct buried
- Available with lockable or sealed clamp

Applications:

- Street Lighting
- Traffic signals,
- Bus stop shelter lighting
- Direction and locality signs
- Public conveniences
- Public telephones
- CCTV Distribution Systems

31 Series UPIC

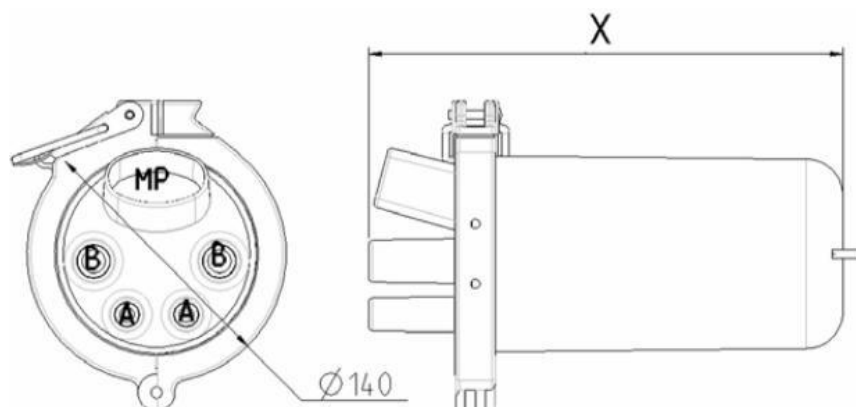

Dimensions

Overall Length - X	Std dome: 260mm
Auxiliary Port - A	Max. Cable Diameter 14.0mm ; Min. Cable Diameter 6.0mm
Auxiliary Port - B	Max. Cable Diameter 18.0mm ; Min. Cable Diameter 6.0mm
Main Port - MP	Max. Cable Diameter 2x 22mm ; Min. Cable Diameter 1x 19mm

PRODUCT CODES - CHANNELL 31 Series UPIC

Product Code	Description
140039	31 Series UPIC Closure kit only with mounting strip, std orange dome

Accessories

Product Code	Description
180022	Maintenance Kit, Auxiliary Heat-shrink Sleeves (pkt 10)
180074	Maintenance Kit, Main Port Heat-shrink Sleeves (pkt 3)

32 Series UPIC

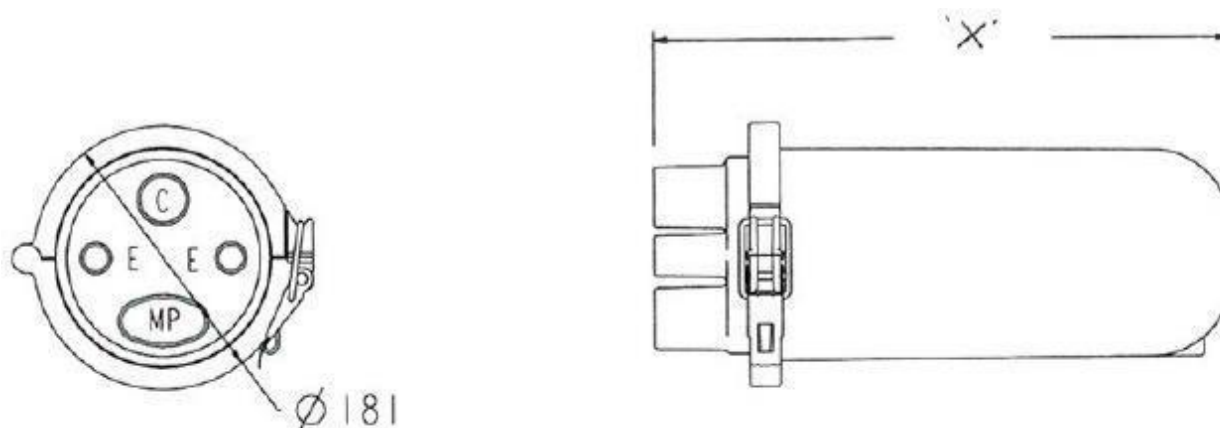

Dimensions

Overall Length - X	Long dome: 350mm
Auxiliary Port - C	Max. Cable Diameter 35.0mm ; Min. Cable Diameter 10.0mm
Auxiliary Port - E	Max. Cable Diameter 20.0mm ; Min. Cable Diameter 6.0mm
Main Port - MP	Max. Cable Diameter 2x 28mm ; Min. Cable Diameter 2x 13mm

PRODUCT CODES - CHANNELL 32 Series UPIC

Product Code	Description
150063	32 Series UPIC SDS Closure kit only with mounting bracket, long dome

Accessories

Product Code	Description
190073	Maintenance Heat-shrink Kit E port (pkt 3)
180240	Maintenance Kit, Main Port Heat-shrink Sleeves inc, Branch Clip (pkt 1)

4 Handholes Products

Channell provides High Density Polyethylene (HDPE) grade level boxes and lids in a variety of depths and sizes for PEDESTRIAN APPLICATIONS.

These boxes are designed to meet the specific fiber, coax and copper needs of the broadband, telecommunications, and utilities industries. They can be used in areas of pedestrian traffic in conjunction with various Channell products in below grade applications.



Handhole covers are secured with an “L” Bolt Cover Security Latch, which can be opened with a hex bolt socket

4.1 GLB series handholes



GLB610

Snap-in Cover

Top Diameter: 6.0”
(152.4mm)

Depth: 10.0” (254.0mm)

Bottom Inside Diameter: 8.5”
(215.9mm)



GLB912

L-Bolt Cover

Top Diameter: 9.5”
(241.3mm)

Depth: 12.0” (304.8mm)

Bottom Inside Diameter:
12.5” (317.5mm)



GLB1111

L-Bolt Cover

Top Inside Dimensions:

11.0” Width X 11.0” Length
(279.4mm X 279.4mm)

Depth: 16.0” (406.4mm)

GLB1015

L-Bolt Cover

Top Inside Dimensions:

10.0" Width X 15.0"

Length (254mm X 381mm)

Depth: 12.0" or 18.0" (304.8mm or 457.2mm)

12" depth shown

GLB1419

L-Bolt Cover

Top Inside Dimensions:

10.0" Width X 15.0" Length

(254.0mm X 382.0mm)

Depth: 12.0" (304.8mm)

Bottom Inside Dimensions:

14.0" Width X 19.0" Length (355.6mm X 482.6mm)

GLB1620

L-Bolt Cover

Top Inside Dimensions:

16.0" Width X 20.0" Length

(406.4mm X 508.0mm)

Depth: 18.0" (457.2mm)

PRODUCT CODES - CHANNELL Handholes

Product Code	Description
GLB6101T11	GLB, CHANNELL, 610, TELECOMM LOGO, BLK BODY, GRN LID,
GLB9121T11	GLB, CHANNELL, 912, TELECOMM LOGO, BLK BODY, GRN LID, L-BOLT
GLB1419121T11	GLB, CHANNELL,1419, TELECOM LOGO, BLACK BODY, GREEN LID, L-BOLT
GLB1012181T11	GLB, CHANNELL,1015, 12" D, TELECOM LOGO, BLACK BODY, GREEN LID, L-BOLT
GLB1015181T11	GLB, CHANNELL,1015, 18" D, TELECOM LOGO, BLACK BODY, GREEN LID, L-BOLT
GLB1419121T11	GLB, CHANNELL,1419, 12" D, TELECOM LOGO, BLACK BODY, GREEN LID, L-BOLT
GLB1620181T11	GLB, CHANNELL,1620, 18" D, TELECOM LOGO, BLACK BODY, GREEN LID, L-BOLT

5 Slam Lock Products

Channell has introduced a strong secure range of HDPE circular handhole pits, called SLAM LOCK. This product has a strong HDPE base and uses the patented Shield technology for the cover. Also introduced with this product is the Channell “SLAM LOCK” fastening mechanism which provides a quick, toolless, secure fastening method to reseal the cover. When the cover seated into the base it will automatically lock into position eliminating any possibility potential safety hazard for the workplace or the greater community.

5.1 Slam Lock series handholes

Two sizes are available

- GLBSL1212 - 12" (305mm Ø) x 12" (305mm D)
- GLBSL1224 - 12" (305mm Ø) x 24" (610mm D)



6 Vault / Pit Products

Channell has developed the most advanced pit and chamber technology in the world with the patented BULK series Vaults and SHIELD cover design



The BULK's HDPE vault design delivers an incredible 27tons of vertical load carrying capacities in a lightweight construction package that exceeds the vertical load carrying capacities of concrete, polymer concrete, and many other body materials. Easy to deploy & adapt to site requirements the BULK series vault takes installation efficiencies to THE NEXT LEVEL.

The SHIELD cover meets or exceeds 15 tons load rating while being 50% lighter than concrete, polymer concrete. SHIELD covers are tested to the highest standards available in the global market and Channell is proud to have pioneered Endurance Stress Testing (EST™) which analyzes cover fatigue in the field. EST™ provides essential data on the life expectancy of a SHIELD lid in the field and confirms its potential life expectancy.

BULK / SHIELD Features:

- Durable/Lightweight/Strong (TIER 22)
- Highest Load Rating to Weight Ratio in the Industry
- Vertical and Horizontal Rib Design
- Embedded Vertical Racking
- Reduced Installation Cost
- Upgradeable Cover Sets
- Superior Fatigue Resistance (EST)™
- Anti-Seize Bolt Technology
- Patented Anti-Slip Technology - Industry Leader in Anti-Trip Hazard Prevention
- Fire Retardant
- Chemical Resistance
- UV stable
- WiFi transparent



BULK / SHEILD Testing Criteria:

Bodies meet or exceed

- Telecordia GR-902-CORE
- Western Underground Committee Guide 3.6
- ANSI/SCTE 77 2013-TIER 22
- EN 124 Class B125/C250
- ASTM-457
- AASHTO M-306 (H-20/25)
- AS3996-Class B - D

Covers meet or exceed

- EST™ 3 Million Cycles
- Telecordia GR-902-CORE
- Western Underground Committee Guide 3.6
- ANSI/SCTE 77 2013-TIER 22
- EN124 Class B125

BULK VAULTS are test BEYOND ALL International Standards, across all rated classes as a COMPLETE Manhole & Cover assembly

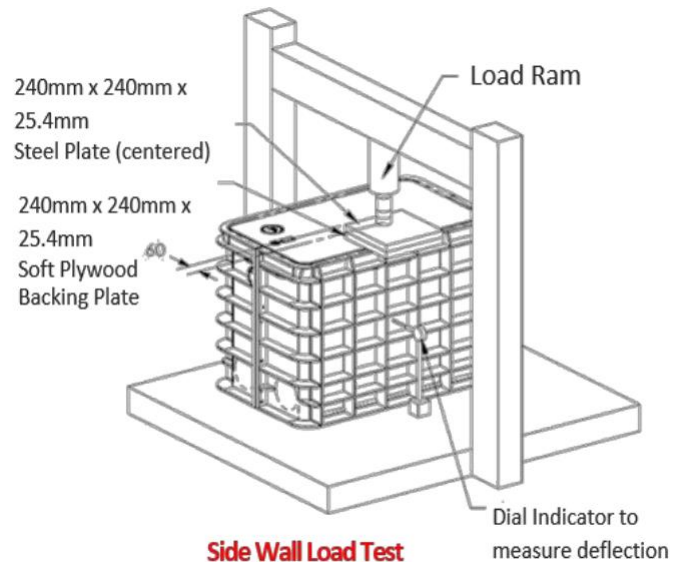
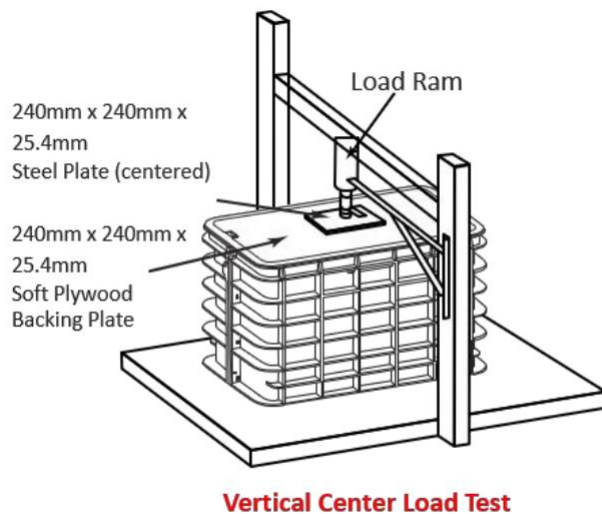

NO STRUCTURAL DAMAGE AFTER

150kN (15 Tons-Force) Shield Cover Test

Or

250kN (25 Tons-Force) Ductile Iron Cover Test

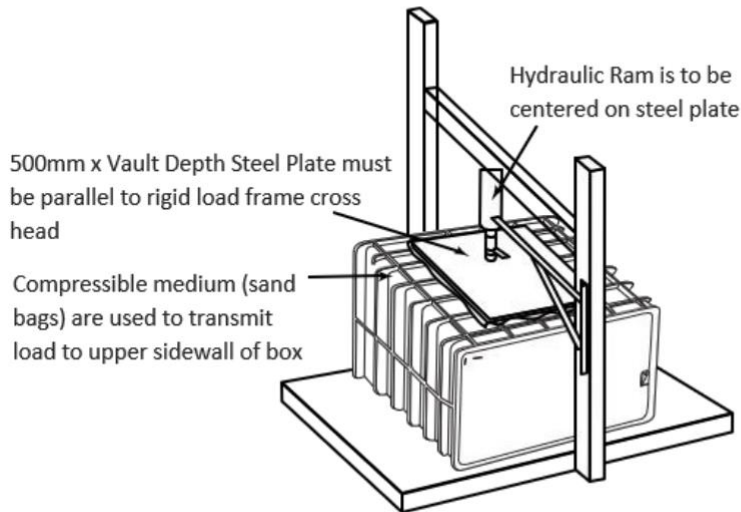

**NO STRUCTURAL DAMAGE
AFTER
15kN
1.5 Tons-Force**

Box Lateral Side Wall Load Test

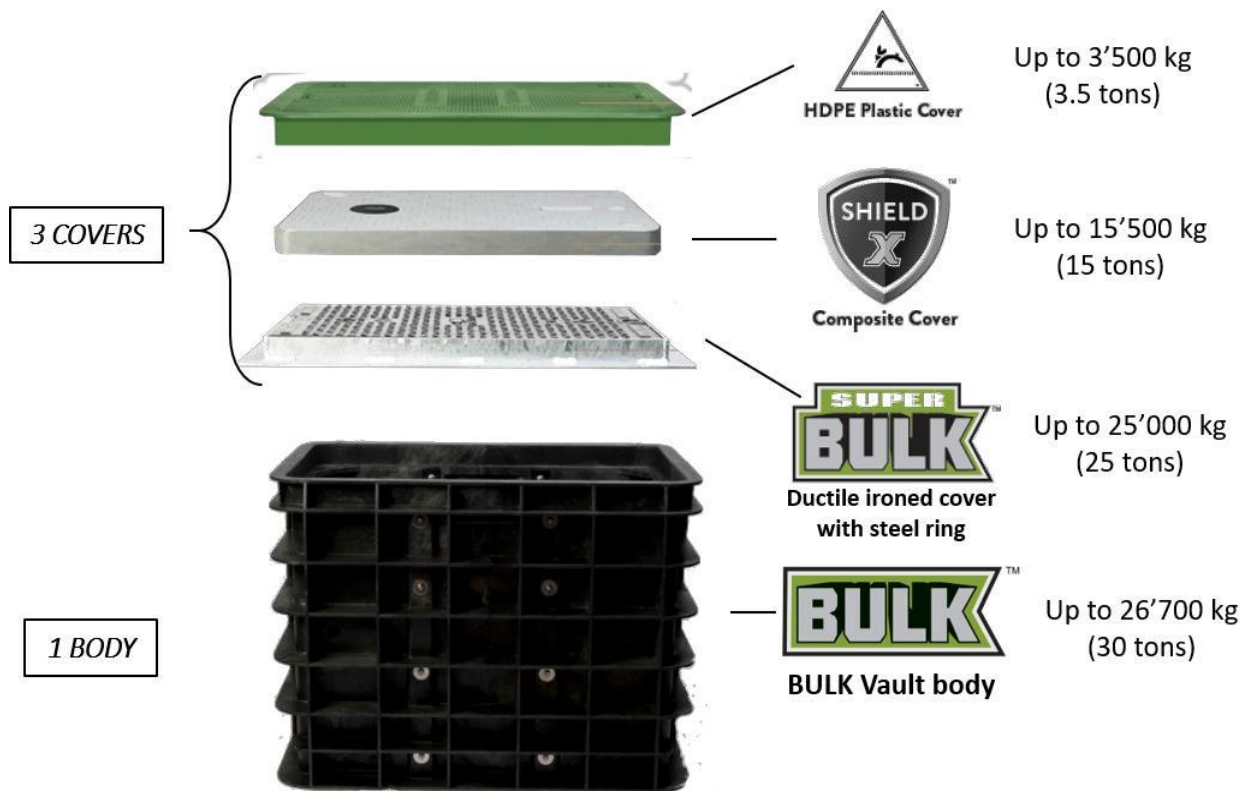

1- BODY & 3 - COVER SET OPTIONS

BULK BODY DESIGN:



- Straight wall design improves lid load strength.
- Flush mounted racks enhance sidewall and vertical strength of pit while increasing usable space.
- Ribbed sidewall design secures
- body into backfill soil and eliminates sidewall deflection.
- HDPE bodies provide easy field alteration while eliminating water absorption and material degradation while maintaining structural integrity and eliminating toxic fiberglass dust.

6.1 CHANNELL BULK SERIES PITS.

The CHANNELL BULK Series pits are arranged into three subgroups

Group	Description	Applicable VAULTS
1	BULK VAULT with HDPE cover set (Load rating is limited to that of the HDPE cover)	BULK1324, BULK1730 BULK2436, BULK3048
2	BULK VAULT with SHIELD cover set (Load rating = 150kN / 15 ton)	BULK0, BULK1 BULK2, BULK3, BULK4, BULK5, BULK7, BULK8, BULK9
3	BULK VAULT with DUCTILE IRON cover set (Load rating = 250kN / 25 ton)	BULK3, BULK4, BULK7

Transport - Channell pits are shipped in a 40" Hi Cube Container and loading is based on the following footprint.

- 20 pallets 1026 x 1229,
- 20 to 21 standard pallets 1000x1200,
- 23 to 24 pallets 800x1200

6.1.1 BULK0 Series Pits (1212)

Channell Product Code	Product Description	Pallet Qty
BULK012N072	BULK SHIELD GLB,1212,12"D, SHIELD LID, NO LOGO, BOLT-DOWN	30

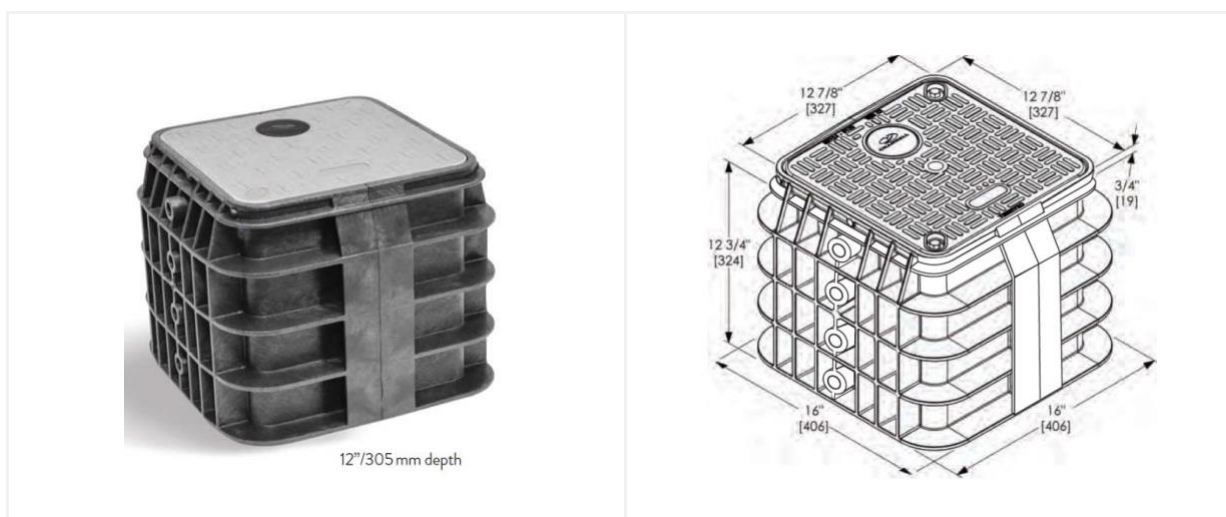

Dimensions

Product Type	Length		Width		Depth		Volumetric
	External	Internal	External	Internal	External	Internal	Working space
BULK012"	406mm	305mm	406mm	305mm	324mm	305mm	0.028m3

Load Rating & Weight	ShieldX Cover	Base Box	ShieldX Cover & Base Box
	150kN (15tons) 1 x 3.6kg	150kN (15tons) 1 x 5kg	8.6kg

Pallet Details	Pallet Qty	40" HC FCL	Total Pallet Weight	Total Pallet Dimensions (approx.) (mm)		
	30	690	260kg	1250(L)	850(W)	1720(H)

6.1.2 BULK1 Series Pits (1118)

Channell Product Code	Product Description	Pallet Qty
BULK118N072	BULK SHIELD GLB,1118,18"D, SHIELD LID, NO LOGO, BOLT-DOWN	18

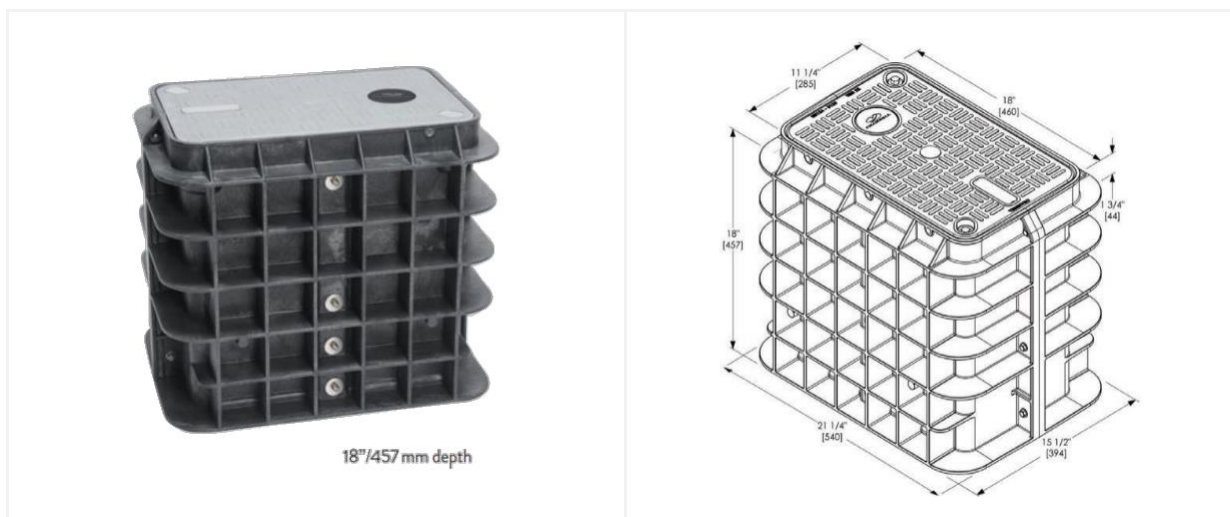

Dimensions

Product Type	Length		Width		Depth		Volumetric
	External	Internal	External	Internal	External	Internal	Working space
BULK118"	540mm	432mm	394mm	254mm	457mm	413mm	0.045m3

Load Rating & Weight	ShieldX Cover	Base Box	ShieldX Cover & Base Box
	150kN (15tons) 1 x 5kg	150kN (15tons) 1 x 10kg	11.5kg

Pallet Details	Pallet Qty	40" HC FCL	Total Pallet Weight	Total Pallet Dimensions (approx.) (mm)		
	18	360	215kgs	1070(L)	1070(W)	1520(H)

6.1.3 BULK2 Series Pits (1324)

Channell Product Code	Product Description	Pallet Qty
BULK218N072	BULK SHIELD GLB,1324,18"D, SHIELD LID, NO LOGO, BOLT-DOWN	16
BULK224N072	BULK SHIELD GLB,1324,24"D, SHIELD LID, NO LOGO, BOLT-DOWN	16

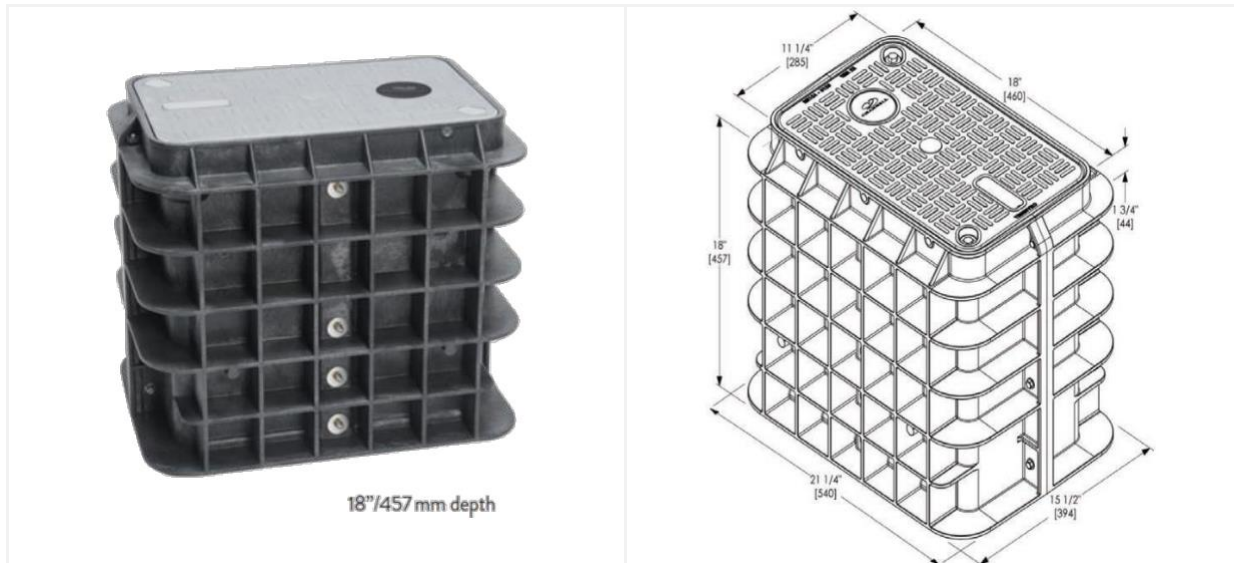

Dimensions

Product Type	Length		Width		Depth		Volumetric
	External	Internal	External	Internal	External	Internal	Working space
BULK218"	699mm	565mm	460mm	324mm	476mm	424mm	0.078m3
BULK224"	699mm	565mm	460mm	324mm	610mm	558mm	0.102m3

Load Rating & Weight	HDPE Cover (PED Traffic)	ShieldX Cover	Base Box	ShieldX Cover & Base Box
	13.5kN (1.38tons) 1 x 3kg	150kN (15tons) 1 x 7kg	276kN (28tons) 1 x 19kg	26kg

Pallet Details (Based on ShieldX)	Pallet Qty	40" HC FCL	Total Pallet Weight	Total Pallet Dimensions (approx.) (mm)		
	16	228	426kgs	1250(L)	850(W)	1905(H)

6.1.4 BULK3 Series Pits (1730)

Channell Product Code	Product Description	Pallet Qty
BULK324N072	BULK SHIELD GLB,1730,24"D, SHIELD LID, NO LOGO, BOLT-DOWN	4
BULK1730244N1020	BULK GLB, 24"DEEP, DUCTILE IRON, BLACK, BOLT-DOWN, NO LOGO	4



Dimensions

Product	Length		Width		Depth		Volumetric
Type	External	Internal	External	Internal	External	Internal	Working space
BULK324"	847mm	749mm	552mm	419mm	610mm	558mm	0.175m3

Load Rating & Weight	HDPE (HD) Cover (PED Traffic)	ShieldX Cover	Ductile Iron (inc frame)	Base Box	HDPE (HD) or Shield (SH) or Ductile Iron (DI) Cover
	8.9kN 907kg 1 x 6kg	150kN 15tons 1 x 12kg	250kN 25tons 78kg (1lid)	276kN (28tons) 1 x 20kg	26kg (HD) 32kg (SH) 63kg (DI)

Pallet Details (Based on ShieldX)	Pallet Qty	40" HC FCL	Total Pallet Weight	Total Pallet Dimensions (approx.) (mm)		
	4	184	138kgs	1250(L)	850(W)	1250(H)

These pallets are be double stacked in a 40" High Cube container

6.1.5 BULK4 Series Pits (2436)

Channell Product Code	Product Description	Pallet Qty
BULK424N072	BULK SHIELD GLB,2436,24"D, SHIELD LID, NO LOGO, BOLT-DOWN	6
BULK436N072	BULK SHIELD GLB,2436,36"D, SHIELD LID, NO LOGO, BOLT-DOWN	4
BULK2436244N1020	BULK GLB, 24"DEEP, DUCTILE IRON LID, BLACK, BOLT-DOWN, NO LOGO	2
BULK2436364N1020	BULK GLB, 36"DEEP, DUCTILE IRON LID, BLACK, BOLT-DOWN, NO LOGO	2



Dimensions

Product Type	Length		Width		Depth		Volumetric
	External	Internal	External	Internal	External	Internal	Working space
BULK424"	1036mm	873mm	731mm	578mm	610mm	533mm	0.269m3
BULK436"	1036mm	873mm	731mm	578mm	914mm	837mm	0.422m3

Load Rating & Weight	HDPE (HD) Cover (PED Traffic)	ShieldX Cover	Ductile Iron (inc frame)	Base Box	HDPE (HD) or Shield (SH) or Ductile Iron (DI) Cover
24" & 36"	10kN 1000kg 1 x 11kg	150kN 15tons 1 x 23kg	250kN 25tons (TBC)	276kN (28tons) 1 x 25kg	36kg (HD) 48kg (SH) (TBC)kg (DI)

Pallet Details (24" / 36")	Pallet Qty	40" HC FCL	Total Pallet Weight	Total Pallet Dimensions (approx.) (mm)		
	6/4 (SH) 4 (DI)	120/92 (SH) 92 (DI)	202/152kgs (SH) 582kgs (DI)	1250(L)	850(W)	1868(H)

6.1.6 BULK5 Series Pits (2448)

Channell Product Code	Product Description	Pallet Qty
BULK524N072	BULK SHIELD GLB,2448,24"D, SHIELD LID, NO LOGO, BOLT-DOWN	1
BULK536N072	BULK SHIELD GLB,2448,36"D, SHIELD LID, NO LOGO, BOLT-DOWN	1



Dimensions

Product Type	Length		Width		Depth		Volumetric
	External	Internal	External	Internal	External	Internal	Working space
BULK536"	1314mm	1180mm	731mm	578mm	914mm	832mm	0.567m3

Load Rating & Weight	ShieldX Cover	Ductile Iron (inc frame)	Base Box	Shield (SH) or Ductile Iron (DI) Cover & Base Box
	150kN (15tons) 2 x 17kg	250kN (25tons) 156kg (2lid)	276kN (28tons) 1 x 52kg	86kg (SH) 208kg (DI)

Pallet Details	Pallet Qty	40" HC FCL	Total Pallet Weight	Total Pallet Dimensions (approx.) (mm)		
	1 (SH) 1 (DI)	50 (SH) 50 (DI)	96kgs (SH) 218kgs (DI)	1250(L)	850(W)	1014(H)

These pallets can be double stacked in a 40" High Cube container

6.1.7 BULK7 Series Pits (3048)

Channell Product Code	Product Description	Pallet Qty
BULK736N072	BULK SHIELD GLB,3048,36"D, SHIELD LID, NO LOGO, BOLT-DOWN	1
BULK3048364N1020	BULK GLB, 36"DEEP, DUCTILE IRON, BLACK, BOLT-DOWN, NO LOGO	1



Dimensions

Product Type	Length		Width		Depth		Volumetric
	External	Internal	External	Internal	External	Internal	Working space
BULK736"	1333mm	1212mm	883mm	764mm	914mm	865mm	0.698m3

Load Rating & Weight	HDPE (HD) Cover (PED Traffic)	ShieldX Cover	Ductile Iron (inc frame)	Base Box	HDPE (HD) or ShieldX (SH) or Ductile Iron (DI) Cover & Base Box
	10kN	150kN	250kN	276kN	41kgs (HD)
	1000kg	25tons	25tons	28tons	105kgs (SH)
	36kg (2 lids)	46kgs (2 lids)	(TBC kgs) (3lids)	59kgs	TBC (DI)

Pallet Details	Pallet Qty	40" HC FCL	Total Pallet Weight	Total Pallet Dimensions (approx.) (mm)		
	1 (SH) 1 (DI)	42 (SH) 42 (DI)	115kgs (SH) 183kgs (DI)	1250(L)	850(W)	1014(H)

These pallets can be double stacked in a 40" High Cube container

6.1.8 BULK8 Series Pits (3660)

Channell Product Code	Product Description	Pallet Qty
BULK836N072	BULK SHIELD GLB,3660, 36"D, SHIELD LID, NO LOGO, BLOT-DOWN	1
BULK848N072	BULK SHIELD GLB,3660, 48"D, SHIELD LID, NO LOGO, BLOT-DOWN	1

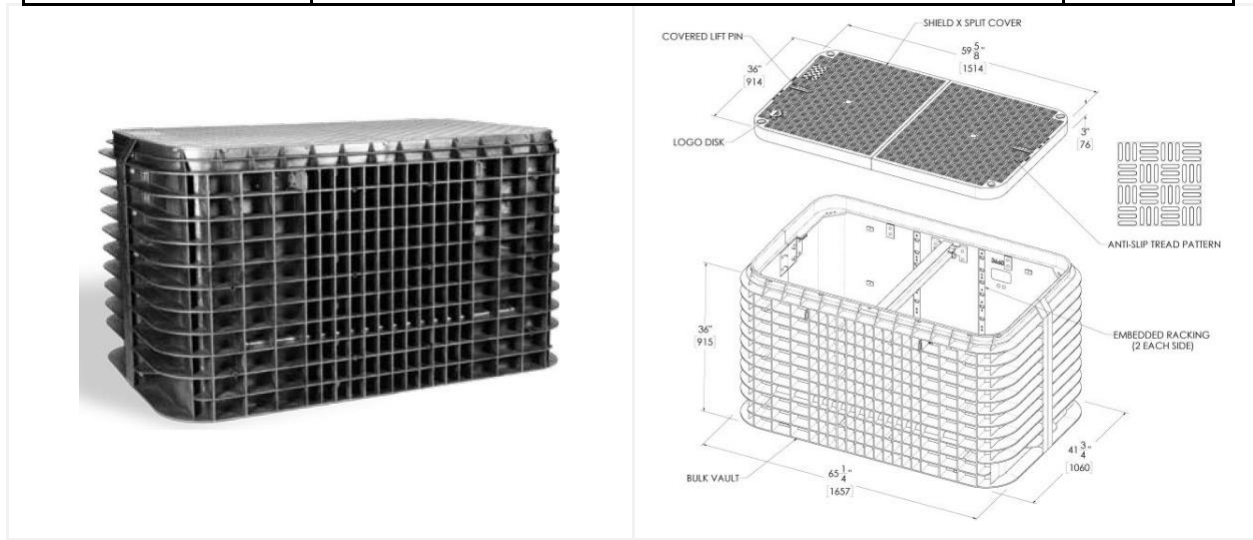

Dimensions

Product Type	Length		Width		Depth		Volumetric
	External	Internal	External	Internal	External	Internal	Working space
BULK836"	1657mm	1480mm	1060mm	883mm	914mm	829mm	1.083m3
BULK848"	1657mm	1480mm	1060mm	883mm	1219mm	1130mm	1.476m3

Load Rating & Weight 36" & 48"	ShieldX Cover	Base Box	ShieldX (SH) & Base Box
	150kN 15tons 2 x 36kg	276kN (28tons) 1 x 86kg	158kg (SH) Not available in SUPER BULK (with Ductile Iron Cover)

Pallet Details 36"	Pallet Qty	40" HC FCL	Total Pallet Weight	Total Pallet Dimensions (approx.) (mm)		
	1 (SH)	42 (SH)	168kgs (SH)	1250(L)	850(W)	1014(H)

These pallets can be double stacked in a 40" High Cube container

6.1.9 BULK9 Series Pits (3676)

Channell Product Code	Product Description	Pallet Qty
BULK942N072	BULK SHIELD GLB,3676, 42"D, SHIELD LID, NO LOGO, BLOT-DOWN	1

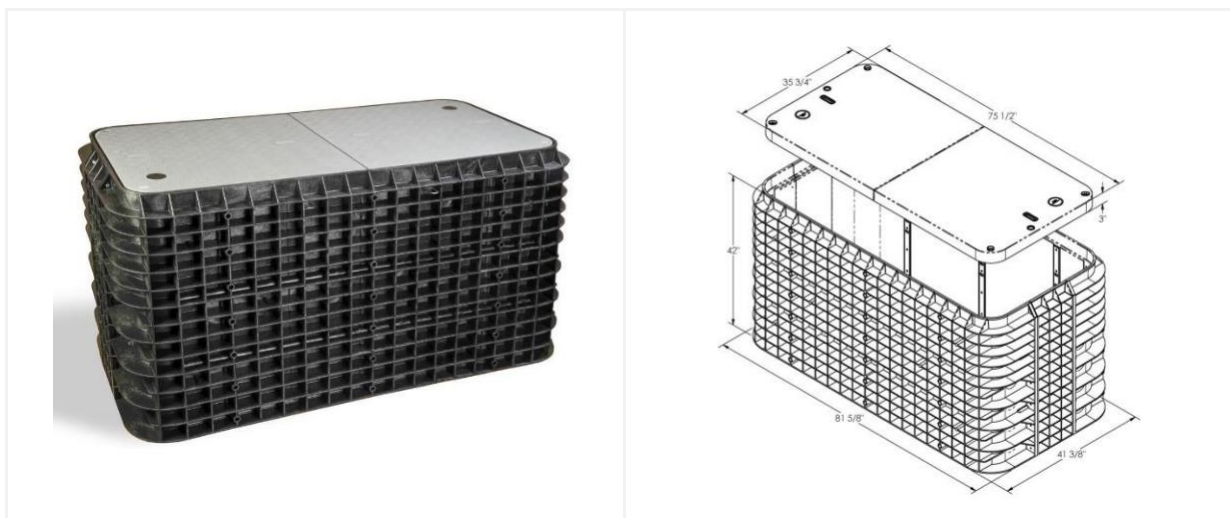

Dimensions

Product Type	Length		Width		Depth		Volumetric
	External	Internal	External	Internal	External	Internal	Working space
BULK942"	2065mm	1910mm	1061mm	913mm	1066mm	991mm	1.728m3

Load Rating & Weight	ShieldX (SH)	Base Box	ShieldX (SH) & Base Box
	150kN (15tons) (SH) 2 x 40kg (SH)	276kN (28tons) 1 x 158kg	238kg (SH) Not available in SUPER BULK (with Ductile Iron Cover)

Pallet Details	Pallet Qty	40" HC FCL	Total Pallet Weight	Total Pallet Dimensions (approx.) (mm)		
	1 (SH)	30 (SH)	248kgs (SH)	1250mm	850mm	1166mm

These pallets can be double stacked in a 40" High Cube container

6.1.10 BULK Accessories

BULK Identification Pucks & Shield Caps



Channell Product Code	Product Description	QTY
ACC03G07734-WA	Channell Cover Puck – WATER (PKT 250) BLUE	1
ACC03G07734-WW	Channell Cover Puck – SEWER (PKT 250) RED	1
ACC03L07734-E	Channell Cover Puck - ELECTRICITY (PKT 250) ORANGE	1
ACC03507734-T	Channell Cover Puck – TELECOMMUNICATIONS (PKT 250) GRAY	1
ACC03007734-B	Channell Cover Puck – BLANK (PKT 250) GRAY	1
PL06507849	BULK CAPS, SHIELD BOLT-DOWN HOLE, ABS GREY (60-PK)	1
PL06507772	BULK CAPS, SHIELD PICK-HOLE, ABS GREY (30-PK)	1



Composite (C)



Steel (S)

BULK Risers

Channell Product Code	Product Description	Qty
BULKARC1730	BULK3 (1730) LID RISER RING (C or S)	EA
BULKARC2436	BULK4 (2436) LID RISER RING (C)	EA
BULKARC3048	BULK7 (3048) LID RISER RING (S)	EA



Base extensions



Base Extensions clips, comes with base extensions

BULK Base Extensions

Channell Product Code	Product Description	Qty
BULKA1324-EXT6	BULK2 (1324) EXTENSION 160mm (6") BLACK	EA
BULKA1730-EXT10	BULK3 (1730) EXTENSION 250mm (10") BLACK	EA
BULKA2436-EXT10	BULK4 (2436) EXTENSION 250mm (10") BLACK	EA
BULKA2448-EXT14	BULK5 (2448) EXTENSION 355mm (14") BLACK	EA
BULKA3048-EXT14	BULK7 (3048) EXTENSION 355mm (14") BLACK	EA

BULK Base Floors

Channell Product Code	Product Description	Qty
BULKAFL1324	FLOOR, BULK1324 (BLACK)	EA
BULKAFL1730	FLOOR, BULK1730 (BLACK)	EA
SGLBAFL2436	FLOOR, BULK4 / SGLB2436 (BLACK)	EA
SGLBAFL2448	FLOOR, BULK5 / SGLB2448 (BLACK)	EA
SGLBAFL3048	FLOOR, BULK7 / SGLB3048 (BLACK)	EA



BULK FLOOR



BULK Hook/Wrench

Channell Product Code	Product Description	Qty
HK02240	HOOK/WRENCH w/TRI-LOBE SOCKET COMBINATION TOOL	EA

BULK Ductile Iron Cover Sets

Channell Product Code	Product Description	Qty
BULK3N112	BULK3 DUCTILE IRON INT'L LID & STEEL RING, HEX BOLT (ACCESSORY-EA)	EA



BULK3 Ductile Iron Cover Set.

6.1.11 BULK Series Rapid Locate System for Shield Cover set.

The Channell “Rapid Locate” feature provides access to locate wires without the need for separate and unsightly locate pedestal or post, or the need to remove the pit cover.

The “Rapid Locate Mechanism” makes locating Quick, Safe, Easy and Secure.

The “Rapid Locate” benefits are:

- **Rapid Locate is Safe** – no exposed hole in the ground when the locator is away from the vault. The retractable mechanism can simply be covered with a safety cone.
- **Rapid Locate is Easy and Quick** because the cover does not have to be removed to perform a locate, no cables/locate wires are disconnected, and a solid ground is available on the isolation switch.
- **Rapid Locate provides Network Security** because if the isolation switch is accidentally left in the “disconnect” position, all cables are bonded back together when the hatch/door is reinstalled.
- **Rapid Locate beautifies an install in a Right-of-Way** as there is no need for a locate pedestal or post.
- **Rapid Locate is Cost Effective** as there is no need for an external pedestal/post, less copper wire is required, no construction cost for routing cables/locate wires through conduit and into an external pedestal/post.
- **Rapid Locate is Secure** because you do not have an external pedestal/post exposed to vandalism, vehicular traffic, and large mowers in a Right-of-Way; or extra copper wire that is attractive to thieves



The SHIELD Rapid Locate cover is secured with a standard Shield Bolt-Down fixture

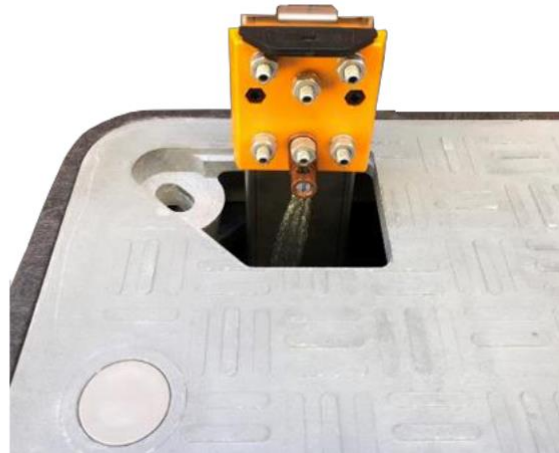

Rapid Locate mechanism with pull up isolation tab. Tap



PRODUCT CODES - CHANNELL Rapid Locate

Product Code	Description
TBA	TBA

7 Fibre Products

Channell has a full range of fibre products that fall into the following categories

- Fibre Dome Closures - Heat-shrink
- Fibre Dome Closures - Grommet technology
- Fibre Inline Closures
- Fibre Pedestals
- Fibre Cabinets
- Integrated fibre Solutions
- Fibre Cable



GREEN HORNET - BUTT SPLICE CONFIGURATION CLOSURE SERIES, ENVIRONMENTALLY SEALED
YELLOW JACKET - INLINE CONFIGURATION CLOSURE SERIES, ENVIRONMENTALLY SEALED
FLASH - PEDESTAL SERIES CLOSURES, ENVIRONMENTALLY SEALED
OPTIMUS - CABINET & PEDESTAL SERIES CLOSURES FREE-BREATHING

7.1 Fibre Dome Closure Series - Heat-Shrinkable

The Channell 1400 & 1500 Series low fibre count closures utilise proven heat-shrink technology to seal cables into the base. These closures support

- Large oval port to accommodate looped cables
- All auxiliary ports are sealed with easy knockouts
- These closures are re-enterable without the need of special tools
- Weatherproof (IP68), insect proof & UV resistant

These closures are recommended for use underground in manholes or joint boxes, or overhead applications on poles or walls.

7.1.1 14000 Series closures

The 14000 series fibre joint closure consists of a base, dome cover, sealing ring and cover clamp. The Dome and base are manufactured from Polypropylene.

The internal fittings consist of a main stalk assembly with double-sided compact splice trays, supporting 2x 6 splice combs inserts per side.

A total of 12 splices are supported on each compact tray with a total of 24 for the double-sided tray, however the fibre splice combs can be easily removed if a PCL 1:4, 1:8 or 1:16 splitter is to be installed into tray.

The 1400 series heat-shrink fibre closures come in two sizes, 14001 & 14002.



14001 Closure
Supports 12 fibre splices

14002 Closure
Supports 24 fibre splices

Dimensions

Overall Length - X	140001 = 256mm ; 140002 = 354mm
Auxiliary Port - A	Max. Cable Diameter 14.0mm ; Min. Cable Diameter 6.0mm
Auxiliary Port - B	Max. Cable Diameter 18.0mm ; Min. Cable Diameter 6.0mm
Main Port - MP	Max. Cable Diameter 2x 22mm ; Min. Cable Diameter 1x 19mm

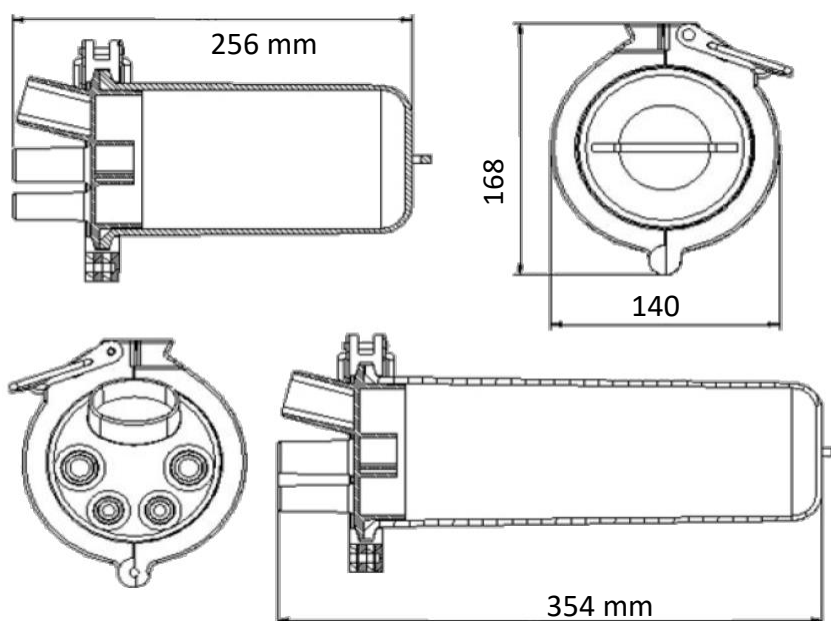

PRODUCT CODES - CHANNELL 14000 Series Fibre Closure

Product Code	Description
140001	Channell 31 Series - 12 Fibre Splice Closure, 2 x 12 fibre Tray, Short Dome
140002	Channell 31 Series - 24 Fibre Splice Closure, 2 x 12 fibre Tray, Short Dome

Accessories

Product Code	Description
180022	Maintenance Kit, Auxiliary Heat-shrink Sleeves (pkt 10)
180240	Maintenance Kit, Main Port Heat-shrink Sleeves (pkt 3)
180242	Pole / Wall Mounted Bracket

7.1.2 15000 Series closures

The 15000 series fibre joint closure consists of a base, dome cover, sealing ring and cover clamp. The Dome and base are manufactured from Polypropylene.

The internal fittings consist of a main stalk assembly with double-sided compact splice trays, supporting 2x 6 splice comb inserts per side. Up to 6 additional compact splice trays can be fitted to main assembly or fibre connector field.

The main splice module supports a 2x compact tray “back to back” and additional splice trays can be added for a total capacity of 96 fusion splices

Each compact splice module is fitted with 2x 6 fibre splice comb

The fibre splice combs can be easily removed if a PCL 1:4, 1:8, 1:16, 1:32 splitter is to be installed into tray.

A patch panel to support SC or LC adapters can be added. This bracket is mounted directly into the compact fibre tray.



15000 Series Closure
Supports 12 – 96 fibre splices

Multiple Trays can be attached
as required

Dimensions

Overall Length - X	150000 = 443mm
Auxiliary Port - A	Max. Cable Diameter 13.0mm ; Min. Cable Diameter 6.0mm
Auxiliary Port - B	Max. Cable Diameter 22.0mm ; Min. Cable Diameter 6.0mm
Main Port - MP	Max. Cable Diameter 2x 13mm ; Min. Cable Diameter 2x 28mm

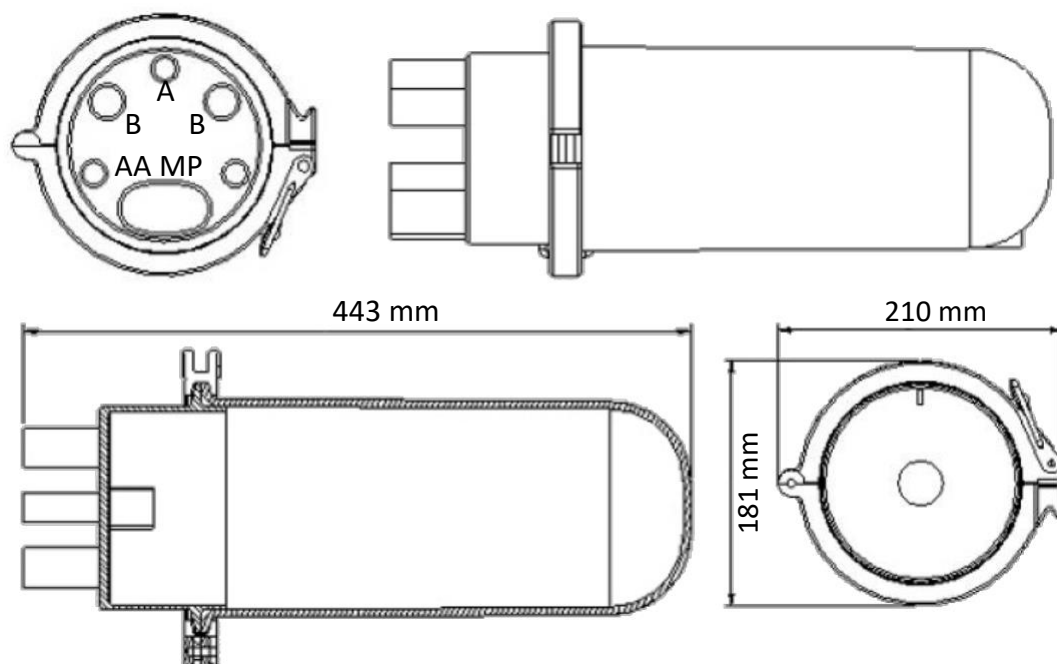

PRODUCT CODES - CHANNELL 15000 Series Fibre Closure

Product Code	Description
150001	Channell 32 Series - 24 Fibre Splice Closure, 2 x 12 fibre Tray
150002	Channell 32 Series - 36 Fibre Splice Closure, 3 x 12 fibre Tray
150003	Channell 32 Series - 48 Fibre Splice Closure, 4 x 12 fibre Tray
150004	Channell 32 Series - 60 Fibre Splice Closure, 5 x 12 fibre Tray
150005	Channell 32 Series - 72 Fibre Splice Closure, 6 x 12 fibre Tray
150028	Channell 32 Series - 96 Fibre Splice Closure, 8 x 12 fibre Tray

Accessories

Product Code	Description
180022	Maintenance Kit, Auxiliary Heat-shrink Sleeves (pkt 10)
180240	Maintenance Kit, Main Port Heat-shrink Sleeves (pkt 3)
180242	Pole / Wall Mounted Bracket



15000 Series Pole / Wall Mounted Bracket



Channell 32 Series - 96 Fibre Splice Closure, 8 x 12 fibre Tray

7.2 Fibre Dome Closure Series – Grommet Technology

The Channell (Green Hornet) G Series fibre closures all incorporate the Channell patented grommet sealing technology. A NON-MECHANICAL, indestructible, toolless, and extremely simple sealing method for all cable types.



The G Series closures support

- Large oval ports to accommodate looped cables
- All branch and drop ports are sealed with removable “O” rings treaded seal assembly
- These closures are re-enterable without the need of special tools
- Weatherproof (IP68), insect proof & UV resistant
- Grommet seals supports all range of round and oval type cable sizes.

The range of G Series closures are:

- G4 series – a small 12-14f closure for Aerial or Underground applications.
- G5 series – a medium 12-144f closure for Aerial or Underground applications.
- G6 series – a medium 12-96f closure for Aerial or Underground applications.
- G9 series – a medium to large up to 1,152f closure for Aerial or Underground applications.

7.2.1 Lubricated Grommet Technology

The G series closures uses Channell’s Patented Grommet Technology which delivers an instant, reliable, and guaranteed environmental seal with superior cable retention.

Key features of Grommet technology are:

- Offers both cable retention and a guaranteed seal in a single unit
- Completely environmentally sealed: air/water-tight, weatherproof, and flood proof (in accordance with Telcordia GR-771-CORE testing requirements)
- Quick, efficient, tool-less installation: on average, takes less than 1 minute to install
- Superior pull out strength
- Accommodates multiple cable configurations
- Long-term structural integrity.



Oval (Figure 8), Branch and drop grommets

G Series Grommets

Port Type	Grommet Type	Min Cable Size	Max Cable Size	Sealing Technology
Oval 50 mm port	Main Oval Port	10.16mm	30.5mm	Channell Grommet Technology
Oval 38 mm port	Main Oval Port	10.16 mm	27.94 mm	
Round 38mm port	Branch Port	10.16mm	27.9mm	
Round 25.4 mm port	Branch Port	10.16 mm	20.3 mm	
Round 19 mm port	Drop 0-2	1.57 mm	3.17 mm	
	Drop 2-3	3.17 mm	4.78 mm	
	Drop 3-4	4.78 mm	6.35 mm	
	Drop 4-5	6.35 mm	7.92 mm	
	Drop 5-6	7.92 mm	9.53 mm	
	Drop 6-7	9.53 mm	11.13 mm	
	Drop 7-8	11.13 mm	12.70 mm	
	Drop 8-9	12.70 mm	14.27 mm	

7.2.2 G4 Series closures

The G4 butt splice closure is a high-performance splice closure capable of performing in the harshest environments. The G4 excels in underground/vault, pedestal, and aerial applications to deliver high-speed fibre communication in any outside plant application.

The G4 series closures can be deployed in many different configurations.

- G4 Standard Configuration
- G4S - Splitter Closure Configuration
- G4HT - Hardened Terminal Configuration



 G4 with 1:8 splitter	<ul style="list-style-type: none"> • Main 38 mm Oval Port for cable range Min 10.16 mm, Max 27.9 mm • 4x 19 mm ports – cable range Min 4.78 mm, Max 14.27 mm 	
	<ul style="list-style-type: none"> • Main 25.4 mm round port for cable range Min 6.35 mm, Max 20.2 mm • 8x 19 mm ports – cable range Min 4.78 mm, Max 14.27 mm 	
	<ul style="list-style-type: none"> • Main 38 mm round port for cable range Min 10.16 mm, Max 27.9 mm • 3x 19 mm ports – cable range Min 4.78 mm, Max 14.27 mm 	

The G4 series closure can be deployed with splitters for both centralized split FTTH networks as well as Distributed Split Networks. It can be used in straight or branch applications with a capacity of up to 24 splices.

The G4 is ideal in FTTH applications where up to eight (8) drops are required at the end of the distribution run.

The oval main cable seal enables mid-sheath cable splices where uncut fibers are stored and expressed through the closure.

The G4 can be deployed with an adapter array housing up to eight (8) SC connectors.



G4 Closure in BULK218 pit



G4 Closure with Thick Wall micro-duct

PRODUCT CODES - CHANNELL G4 Series Fibre Closure

Product Code	Description
TBA	TBA

Accessories

Product Code	Description
180022	Maintenance Kit, Auxiliary Heat-shrink Sleeves (pkt 10)
180240	Maintenance Kit, Main Port Heat-shrink Sleeves (pkt 3)
180242	Pole / Wall Mounted Bracket

7.2.3 G5 Series closures

The G5 butt splice closure is a high-performance splice closure capable of performing in the harshest environments. The G5 excels in underground/vault, pedestal, and aerial applications to deliver high-speed fibre communication in any outside plant application.

The G5 series closures can be deployed in many different configurations.

- G5 Standard Configuration
- G5S - Splitter Closure Configuration
- G5HT - Hardened Terminal Configuration

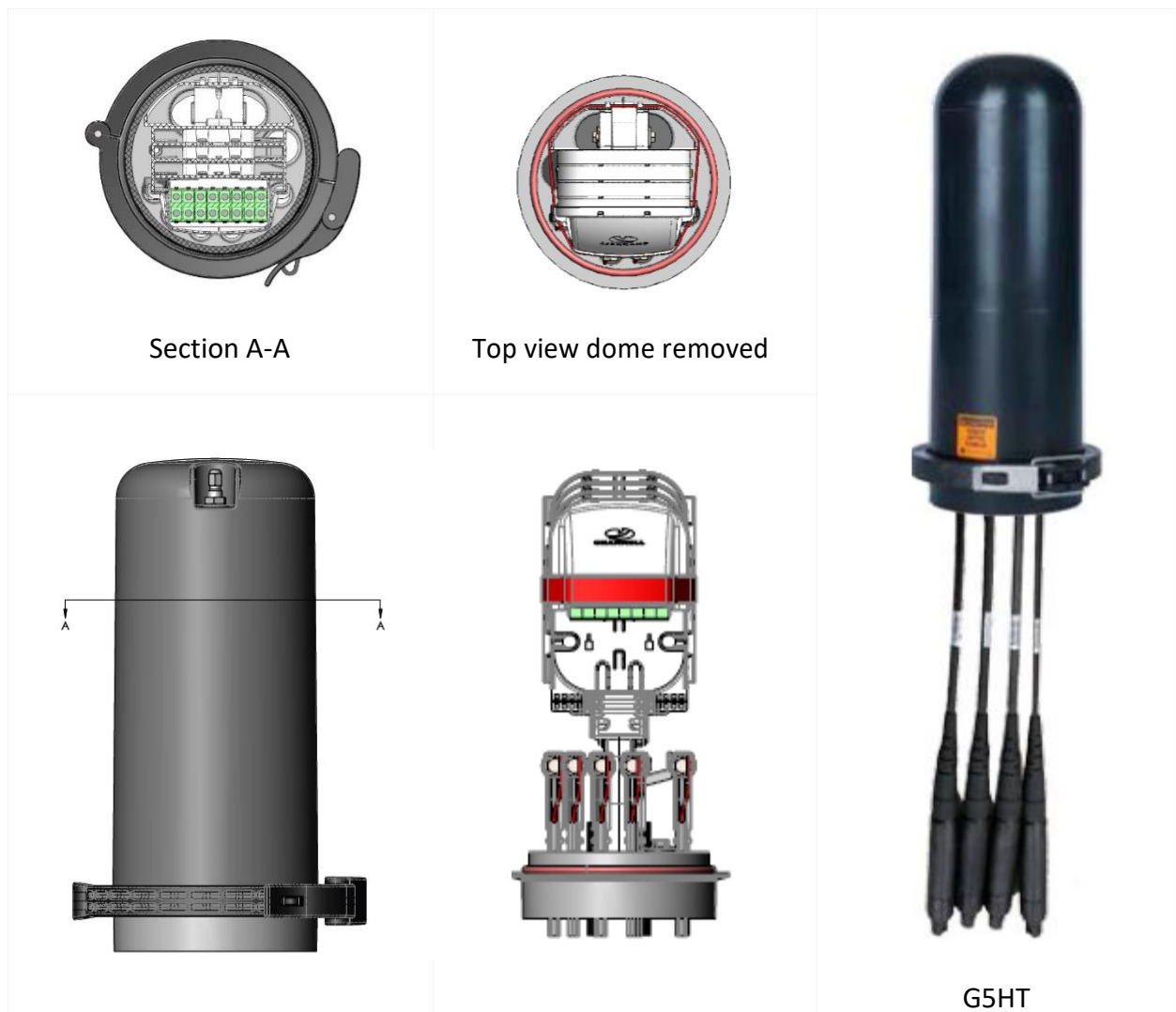

The G5 series closures has two base configurations. A drop only & a drop + branch port configuration.

G5 Port configuration

- Main 38 mm Oval Port for cable range Min 10.16 mm, Max 27.9 mm
- 1x round 38 mm branch port for cable range Min 10.16 mm, Max 20.3 mm
- 8 or 12x 19 mm ports – cable range Min 4.78 mm, Max 14.27 mm



G5 Standard base



G5 Branch port base

Dimensions

- G5L14 closure = 14" (320mm) dome length, total length (dome + base) = 355 mm
- Enclosure outer diameter, excluding clamp: 152.4 mm
- Enclosure outer diameter, including clamp: 241 mm

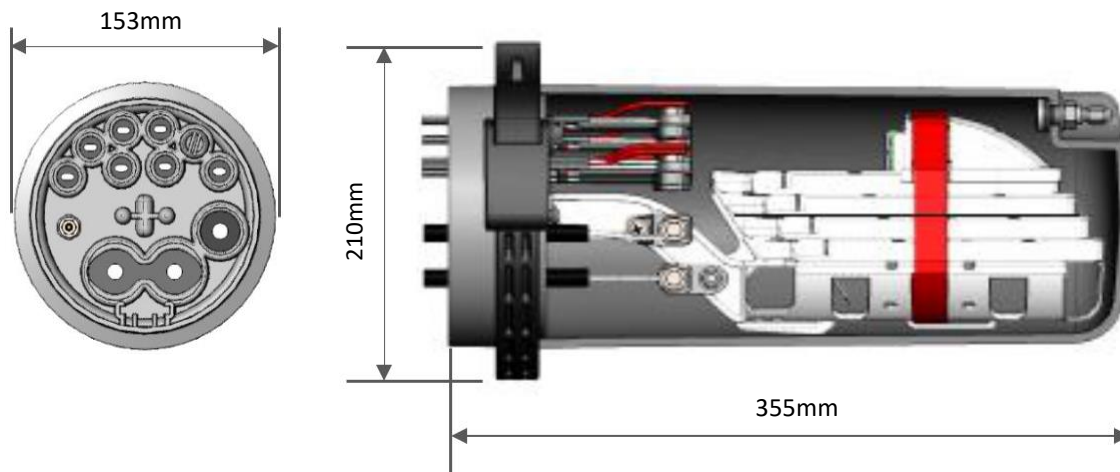

G5 Splice Trays

- The G5 series closure can be used in straight or branch applications with a capacity of up to 144f splices from 4 hinged fibre trays with 24 to 36 splice positions supported in each tray.
- Max single fibre fusion splice is 144f splices (4x 36f = 144f).
- The G5 splice trays also supports ribbon fibre with splice combs

- The G5 can also support splitters for both centralized split FTTH networks and distributed split networks

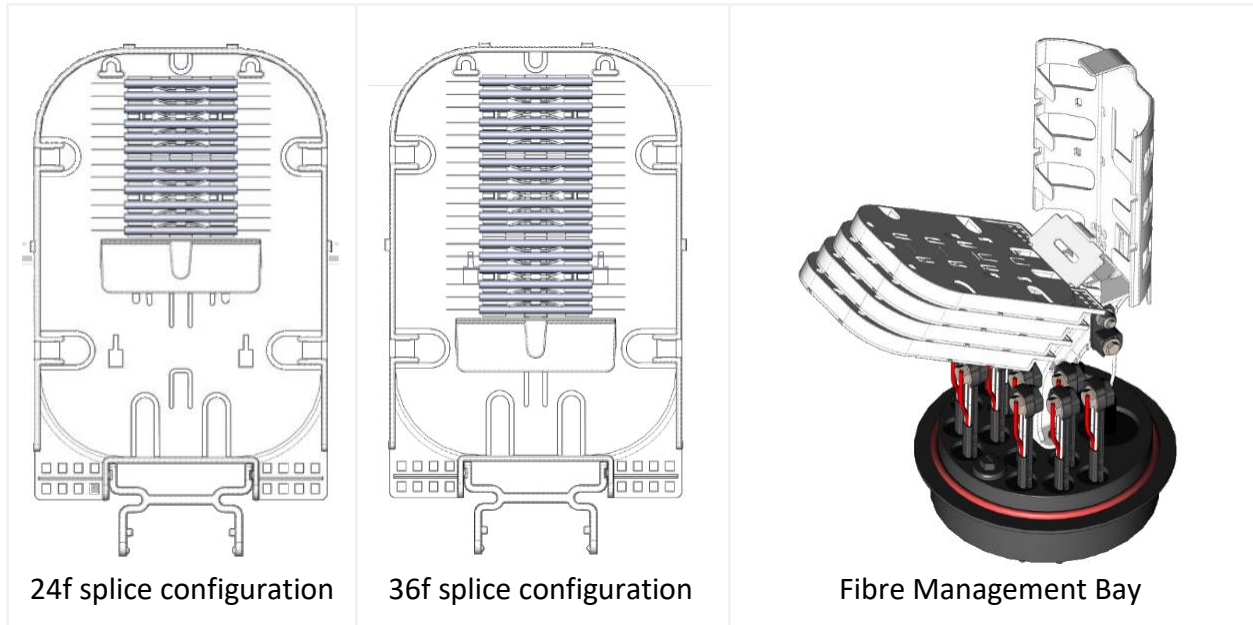

An optional connector field can be attached to the outer splice tray supporting 16x SC/ACP or 32x LC/APC adaptors
G5 in BULK2



G5 Closure in BULK218 pit



G5 Closure on swingarm in BULK218 pit

PRODUCT CODES - CHANNELL G5 Series Fibre Closure

Product Code	Description
TBA	TBA

Accessories

Product Code	Description
GR03116101-34/ GR06116101-34	Drop Port Grommet (3 or 12 Pack) / 0.188-0.250 inches (4.78-6.35 mm)
GR03116101-45/ GR06116101-45	Drop Port Grommet (3 or 12 Pack) / 0.250-0.312 inches (6.35-7.92 mm)
GR03116101-56/ GR06116101-56	Drop Port Grommet (3 or 12 Pack) / 0.312-0.375 inches (7.92-9.53 mm)
GR03116101-67/ GR06116101-67	Drop Port Grommet (3or 12 Pack) / 0.375-0.438 inches (9.53-11.13 mm)

7.2.4 G6 Series closures

The G6 butt splice closure is a high-performance splice closure capable of performing in the harshest environments. The G6 excels in underground/vault, pedestal, and aerial applications to deliver high-speed fibre communication in any outside plant application.

The G5 series closures can be deployed in many different configurations.

- G6 Standard Configuration
- G6S - Splitter Closure Configuration
- G6HT - Hardened Terminal Configuration



G6 Standard configuration



G6 24W fibre tray



G6 with connector field

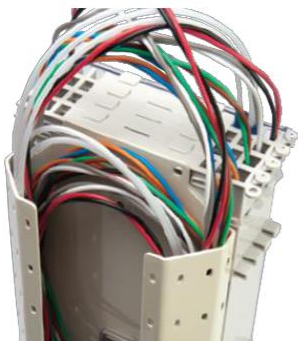

G6 fibre management bay



G6HT

G6 Port configuration

- Main 38 mm Oval Port for cable range
Min 10.16 mm, Max 27.9 mm
- 1x round 38 mm branch port for cable range
Min 10.16 mm, Max 20.3 mm
- 1x 19mm spare port for bonding and
grounding rod
- 16x 19 mm ports – cable range Min
4.78 mm, Max 14.27 mm



G6 Base

Dimensions

- G6L15 closure = 15" (381mm) dome length, total length (dome + base) = 469 mm)
- G6L18 closure = 18" (457mm) dome length, total length (dome + base) = 545 mm)
- Enclosure outer diameter, excluding clamp: 152.4 mm
- Enclosure outer diameter, including clamp: 241 mm

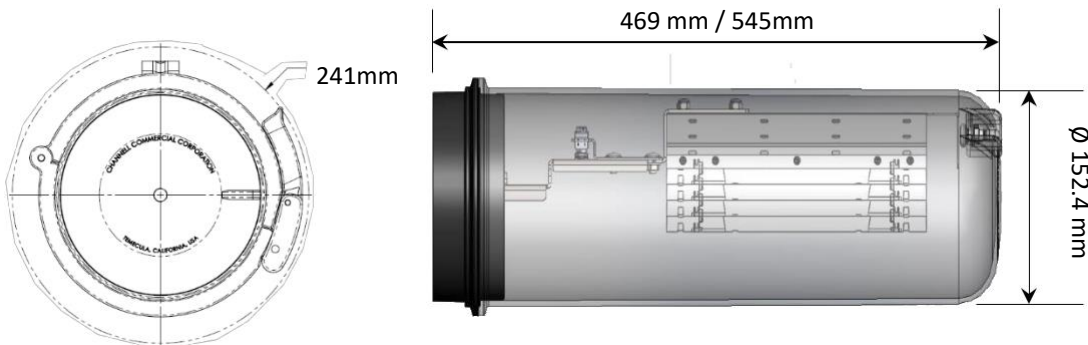

PRODUCT CODES - CHANNELL G6 Series Fibre Closure

Product Code	Description

Accessories

Product Code	Description
GR03116101-34/ GR06116101-34	Drop Port Grommet (3 or 12 Pack) / 0.188-0.250 inches (4.78-6.35 mm)
GR03116101-45/ GR06116101-45	Drop Port Grommet (3 or 12 Pack) / 0.250-0.312 inches (6.35-7.92 mm)
GR03116101-56/ GR06116101-56	Drop Port Grommet (3 or 12 Pack) / 0.312-0.375 inches (7.92-9.53 mm)
GR03116101-67/ GR06116101-67	Drop Port Grommet (3 or 12 Pack) / 0.375-0.438 inches (9.53-11.13 mm)

7.2.5 G9 Series closures

The G9 butt splice closure is a high-performance splice closure capable of performing in the harshest environments. The G9 excels in underground/vault, pedestal, and aerial applications to deliver high-speed fibre communication in any outside plant application.

The G9 dome and base are manufactured from tough, durable engineering thermoplastic materials, with silicon O-ring seals and corrosion resistant clamp fixtures. The base is fitted with threaded port seal assemblies which are removed when grommets are inserted.

The G9 uses Channell's patented grommet technology and will support direct buried, direct install, ADSS, mini cable and both traditional and thick-walled micro ducts for air blown fibre applications.

The internal fittings consist of a main chassis supporting the Channell Single Circuit Management System (SCMS). The Channell SCMS system is module design, consisting of Single Element (SE), Single Circuit (SC), Patch Panel, Fibre Routing modules.

Although the G9 24" (12 Module) will support up to 1152 splices, SCMS capacity varies depending on the mix of SE, SC and patch panels required.

Series closures can be deployed in many different configurations.

- G9 Standard Configuration
- G9S - Splitter Closure Configuration
- G9HT - Hardened Terminal Configuration
- G9MD – Micro-duct configuration



G9 20" (8 Module) Closure

Two base types are available, suitable for direct termination and pass-through cable management.

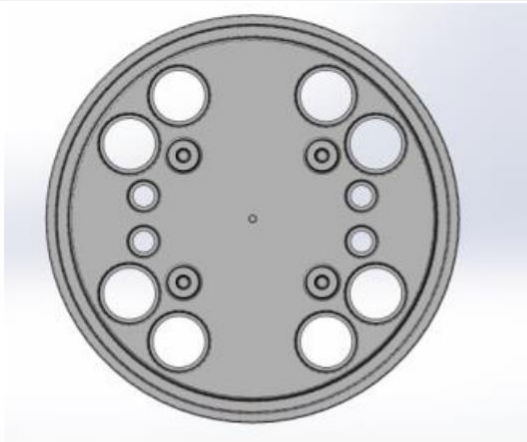

G9 38mm base

- 1. 8x 38mm round ports**
- 2. 4x 19mm round ports**

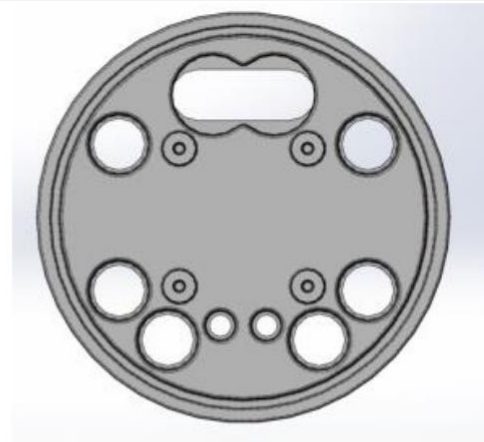

G9 50mm Oval Port base

- 1. 6x 38mm round ports**
- 2. 4x 19mm round ports**
- 3. 1x 50mm Oval port**

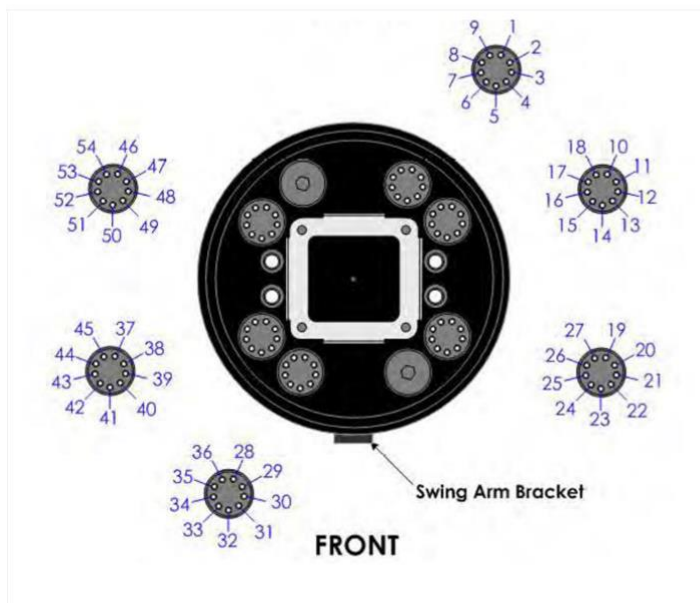

5mm Micro-duct Allocation 8x 38mm base



**Pre-assembled G9 with
10mm & 5mm micro-
ducts installed**

G9 SMC Modules

Standard SE module – 30f/60f splice module

- Supports 6 spliced fibres single stack and 12 fibres double stack on a tray
- 5 trays per module with 30 fibres single stack and 60 fibres double stack per module
- Number of fibre comb variations available that can be snapped into position.
- Fibre comb can be support up to 3x PLC splitters



Slim SE module – 96f splice module

- Supports 12 splices per tray.
- 8 trays per module supporting 96 fibres per module.
- Fixed fibre splice comb, (not interchangeable)

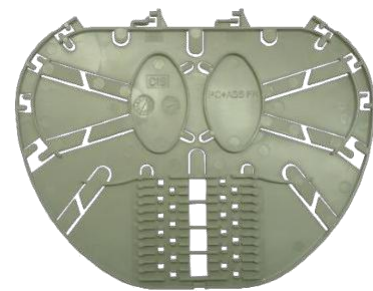

Standard SC module – 32f splice module

- Supports 4 splices per tray.
- 8 trays per module supporting 32 fibres per module.
- Fixed fibre splice comb, (not interchangeable)



Double Density SC module – 64f splice module

- Supports 8 splices per tray.
- Each tray consists of an upper & lower layer hinged at the front of the tray.
- Both layers support 4 splice and together they support 8 splices.
- 8 trays per module supporting 32 fibres per module.
- Fixed fibre splice comb, (not interchangeable)

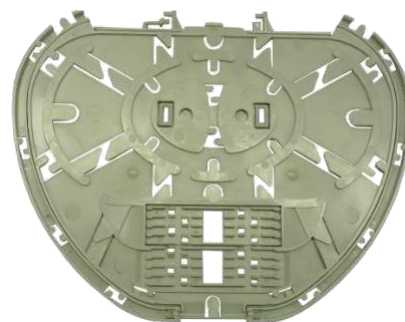

G9 SMC Patch Field

PATCH PANEL MODULE

- Supports 6 x SC or 12x LC Adaptors in ½ size back mount frames.
- 8 patch panels can be attached to one side of a back-mount frame in a 20" closure
- 12 patch panels can be attached to one side of a back-mount frame in a 24" closure



Closure Fibre Capacity

CLOSURE	SE modules	Slim SE modules	SC modules	DDSC modules
G9 20" 8 module positions	480 Splices	768 Splices	256 Splices	512 Splices
G9 24" 12 module positions	720 Splices	1,152 Splices	384 Splices	768 Splices

PRODUCT CODES - CHANNELL G9 Series Fibre Closure

Product Code	Description
G9160002070	G9 / BULK3 (1730) ABFAT, 8x38MM BASE, 48SC/10SE TRAYS, 54x5MM & 4x12MM MICRODUCTS, SHIELD BOLT-DOWN, BLANK LOGO, FLOOR
G9160002149	G9 / BULK3 (1730) ABFAT, 8x38MM BASE, 48 SC / 10 SE TRAYS, 48x7MM 4x12MM MICRODUCTS, SHIELD BOLT-DOWN, BLANK LOGO, FLOOR
G9160002150	G9 / BULK3 (1730) ABFAT, OVAL + 6x38MM BASE, 40 SE TRAYS, SHIELD BOLT-DOWN, BLANK LOGO, FLOOR
TBA	G9 / BULK3 (1730) ABFAT, OVAL + 6x38MM BASE, 48 SC / 10 SE TRAYS, SHIELD BOLT-DOWN, BLANK LOGO, FLOOR

Accessories – G9 MODULES

Product Code	Description
CSC-8A	SINGLE CIRCUIT TRAY 8-TRAY (12 PACK) w/COVER
CSE-5A	SINGLE ELEMENT 5-TRAY (12-PACK) w/COVER
CSC-CVA	SINGLE CIRCUIT MANAGEMENT SC TRAY COVER - PKT 12
CSE-CVA	CIRCUIT MANAGEMENT SE TRAY COVER - PKT 12
CSC-8DD	SINGLE CIRCUIT DOUBLE-DENSITY 8-TRAY (12PACK) w/COVER,
TBA	SINGLE ELEMENT SLIM 8-TRAY (12 PACK) w/COVER
TBA	PATCH PANEL MODULE (12PACK),

Accessories – G9 GROMMETS

GR06006414	DROP TUBE GROMMET, 38MM 9x 5MM BLOWN FIBER (9 x 5MM HOLES) FOR 5MM MICRO DUCT
TG01764	TUBED GROMMET SET 38MM 9x 5MM, BLOWN FIBRE TUBE/GROMMET ASSEMBLY G9
TBA	DROP TUBE GROMMET, 38MM 6x 7MM BLOWN FIBER (6 x 7MM HOLES) FOR 7MM MICRO DUCT
TBA	TUBED GROMMET SET 38MM 6x 7MM, BLOWN FIBRE TUBE/GROMMET ASSEMBLY G9
GR06116213-4SLIT	MAIN OVAL PORT GROMMET 2" FIG8 DRILLED 0.4 SLIT - OVAL GROMMET FOR PASS THROUGH OF ADSS 48F CABLE – PKT OF 12
GR160001394PK	MAIN OVAL PORT GROMMET 2" FIG8 DRILLED 0.6 SLIT - OVAL GROMMET FOR PASS THROUGH OF ADSS 116F CABLE – PKT OF 12
GR06116101-89	GROMMET CARD 3/4" (19MM) - 12 x 1 HOLE GROMMET PKTS FOR 116f ADSS CABLE (12.7>14.27MM) - PKT 12
GR06116101-78	GROMMET CARD 3/4" (19MM) - 12 x 1 HOLE GROMMET PKTS FOR 12/10mm MICRODUCT (11.12>12.7MM) - PKT 12
GR06116101-67	GROMMET CARD 3/4" (19MM) - 12 x 1 HOLE GROMMET PKTS FOR 48f ADSS CABLE (9.53 >11.12MM) - PKT 12

Accessories - OTHER

BR01913K	G9 AERIAL CTM FOR BRANCH PORT - ADSS CTM RETENTION BRACKET FOR SMALL BRANCH PORT- PKT 12
BR01910K	G9 AERIAL CTM FOR OVAL PORT - ADSS CTM RETENTION BRACKET FOR OVAL PORT - PKT 12
SW00550-G9	G9 SWING ASSY KIT
SW00550-G9A1	G9 SWING ASSY KIT, EXTENDED

7.2.6 G9 Fibre Hub closures

The G9 Fibre Hub closures is part of the Channell Fibre Hub series of closures and is an environmentally sealed Fibre Hub designed for centralized split points in PON networks.

Green Hornet Fibre Hub enclosures can be deployed within grade level vaults allowing deployment in areas requiring flush to grade network deployment, or in aerial and pole mount applications.

The 72, 96 and 144 fibre termination choices allow operators to scale enclosures to specific network architectures.



Key Features & Benefits

- Fibre Bend Radius Protection provides timeless performance.
- Intuitive fibre routing provides ease of use and repeatable splitter installation.
- Easy connector access allows easy cleaning access and quick reliable connections.

- Diverse splitter, WDM/Splitter, and CWDM module choice allow deployment in all GPON, EPON, and RFOG deployments as well in both centralized split and decentralized split network configurations.
- Splitter module fits all styles of Fibre Hub enclosures; which minimizes inventory and guarantees that the technician has the right modules to complete the work order.
- Splitter Modules include 1X32, 2x32, 1X16, 2X16, Dual 1X16, 1X8, Quad 1X8, 1X4, Sextuple 1X4, 1X2, and many versions of CWDM and DWDM multiplexer modules.
- Splitter Modules exceed GR-1209 and GR-1221 optical requirements and connect with GR-326 connectors delivering superb optical performance.
- Grommet and O-ring seals deliver water submersion performance.

Green Hornet 144 Fiber Hub

- GFH144CABANAD is an environmentally sealed Fiber Hub. It has a 24 fibre feed and a 144 fiber distribution field and includes all dielectric loose tube fiber stubs (50' long) and a single 1x32 splitter module.
- Green Hornet can be deployed below grade in our BULK vault series; the addition of a swing arm bracket allows above grade ease of use
- Green Hornet can also be pole mounted by simply adding a pole mount bracket
- All connectors are SC/APC and the splitter modules have input and output leads on them to allow a cross-connection between the fiber input and any subscriber output through the splitter for an "on demand" deployment plan
- Additional feed inputs can be used with fiber jumpers to bypass splitters for secure circuits with un-split signals
- Splitters are available in 32, 16, 8, 4 way splits and one splitter module design fits every Fibre Hub designed (Cabinet, Sealed Closure or Pole Mount Cabinet designs) Smaller distribution counts of 72 and 96 fibers are also available

PRODUCT CODES - CHANNELL G9 Series Fibre Closure

Product Code	Description
GFH144CABANAD	TBA

7.3 Fibre Inline Closures

The Channell yellowjacket series In-line closures provide a convenient, reliable and economical means of jointing copper cables either above or below ground.

Manufactured from tough, durable, highly chemical resistance thermoplastic & UV resistance material allows the Yellowjacket to be deployed in the harshest environment. All metal components are either stainless steel or a metal with equivalent corrosion resistance metal. Yellowjacket closures use a bolt & nut securing system to provide compression over the molded silicone gaskets to seal closure and provide long term reliability.

Nominal operating temperatures for these closures are -30°C - 60°C

The closure incorporates in-built fastening points for catenary brackets, suitable for either wire hanging or wall mounting.

Yellowjacket Configuration:

- 4 main cable ports (2x right side & 2x left side)
- 32 drop cable ports (16x right side & 16x left side)
- Separate feeder/distribution and drop fibre management compartments (lower & upper compartments).
- 4x splice trays supporting 12- 36 splices per trays (total capacity 144f) in bottom splice compartment.
- 16x splice comb and 16x SC/APC connector field in upper compartment

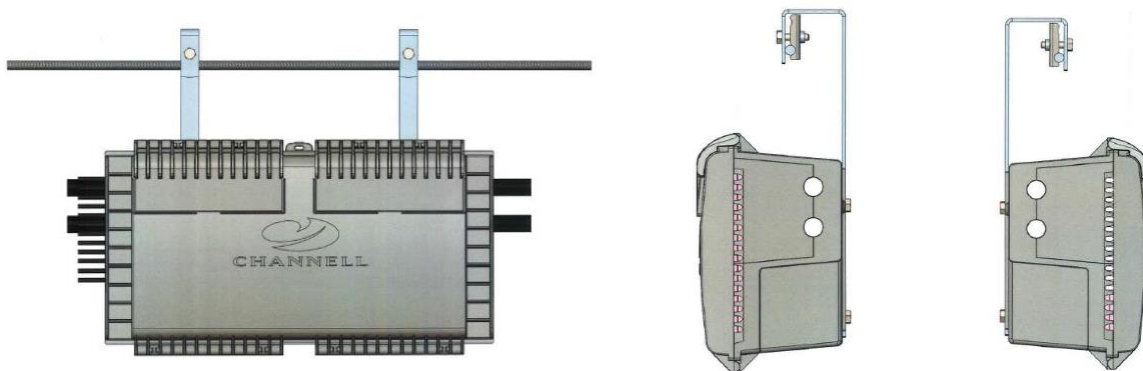

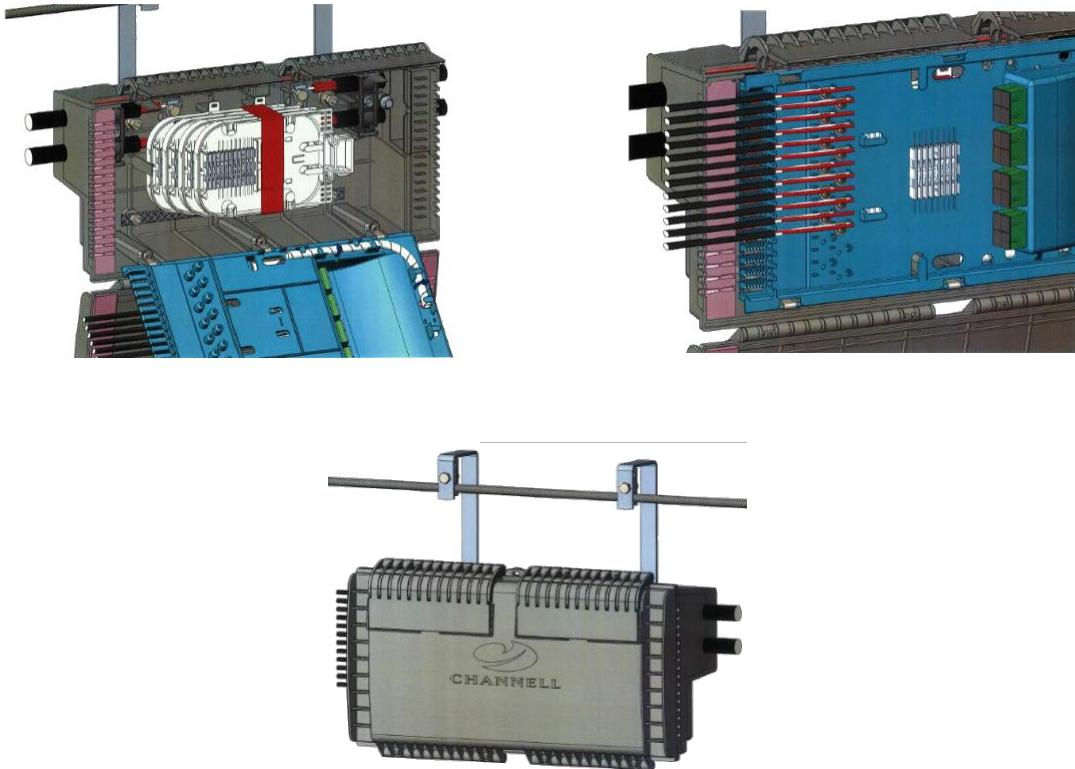

PRODUCT CODES - CHANNELL In-Line Series Fibre Closure

Product Code	Description
TBA	TBA

8 Integrated Fibre Closure Products

The Channell FLASH series products, sees the integration of the Channell environmentally sealed closures (Green Hornet Series) and the BULK series Vaults to deliver a solution that provided maximum asset protection for critical fibre networks.



Integrated Bulk Fibre Closure Series is an advanced solution for backhaul & GPON networks greatly increasing network flexibility, and reduces time to deploy conventional fibre (aerial, ducted, direct buried) and air blown fibre builds

As fibre infrastructure becomes more critical to delivering High Speed Broadband, the Channell UNDERGROUND Fibre Access Terminal provides operators with a secure, out of sight closure eliminating the need for street side cabinets

The Channell sealed environmental integrated underground closure solution ensures a 50year+ performance life considerably longer than the traditional above ground GPON cabinet architecture



Flash 9

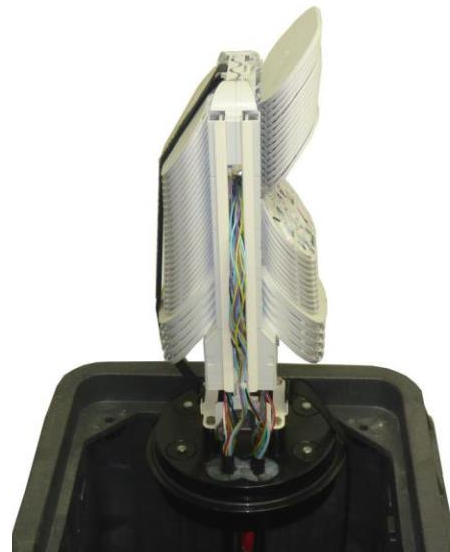

Aerial Flash 9 - AFAT

The Channell Integrated Fibre Closure can be deployed in the feeder, distribution or drop network. Successfully deployed across the network a typical network could appear as below, with Fibre Flexibility Points within the feeder network and Fibre Access Terminals (in this case Air Blown Fibre Access Terminals- ABFAT) in the distribution & Drop networks.

A mix of Aerial Fibre Access Terminals (AFAT), ABFAT, and a comb FAT can happily exist in the same distribution run delivering an extremely flexible FTTH solution.

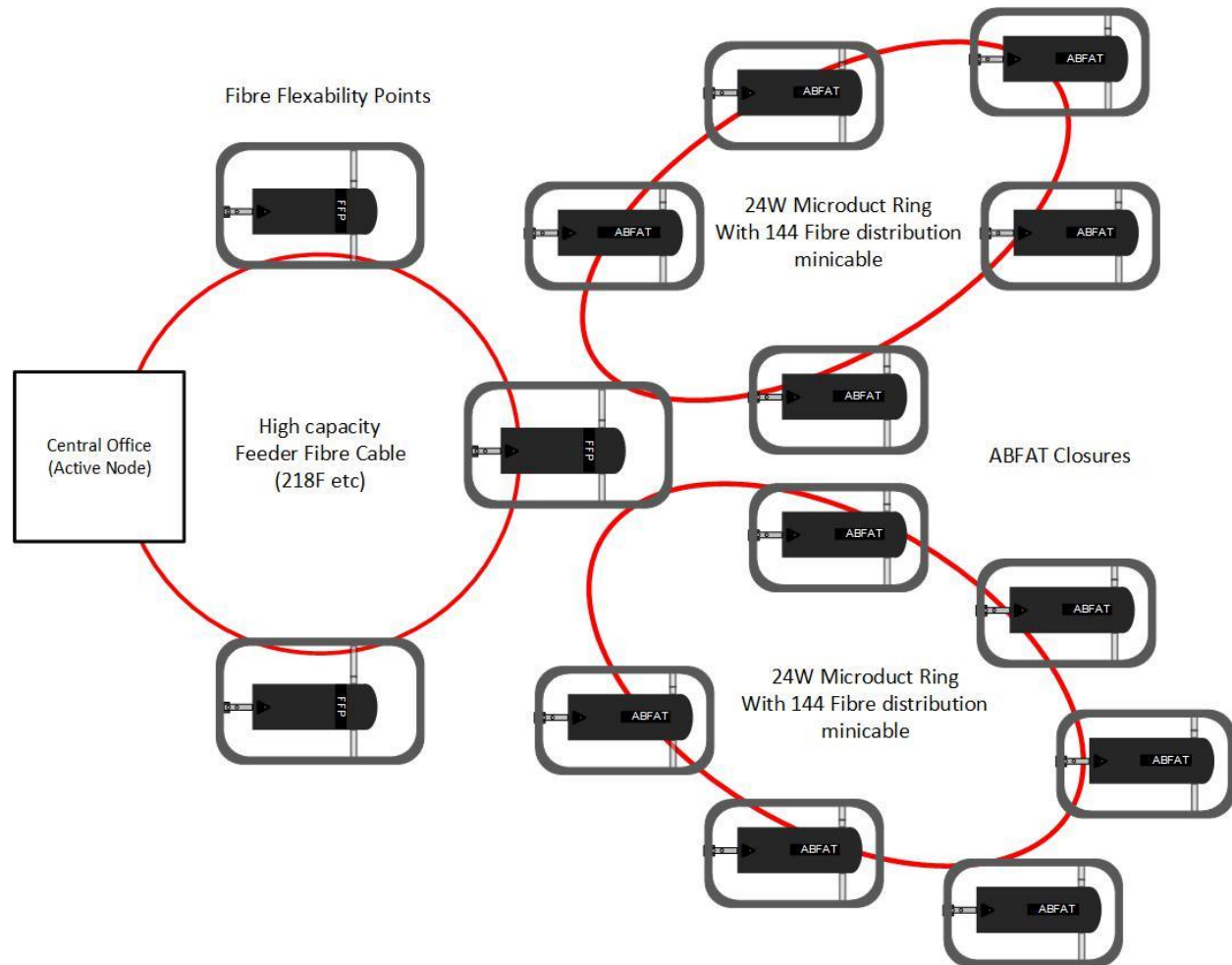

The use of the Channell ABFAT significantly reduces civil and material costs when used in a micro-ducted solution over a traditional FTTH centralised cabinet solution.

The Channell ABFAT solution allows operators to deploy a decentralised split, cascading architecture for GPON FTTH rollouts.

In a typical deployment as below has the following configuration:

- Each ABFAT supports 2x 24Way micro duct entering from either end of the BULK pit
- Each ABFAT services 48 drop micro ducts, 24 drops in each direction A & B of the 24 Way

- Each drop micro duct can support up to a 12 fibre EPFU (12 fibre air blown drop cable)
- Up to 4 drop fibres can be support by the G9 20" ABFAT closure (in BULK3 Pit)
- Up to 12 drop fibres can be support by the G9 24" ABFAT closure (in BULK4 Pit or larger)

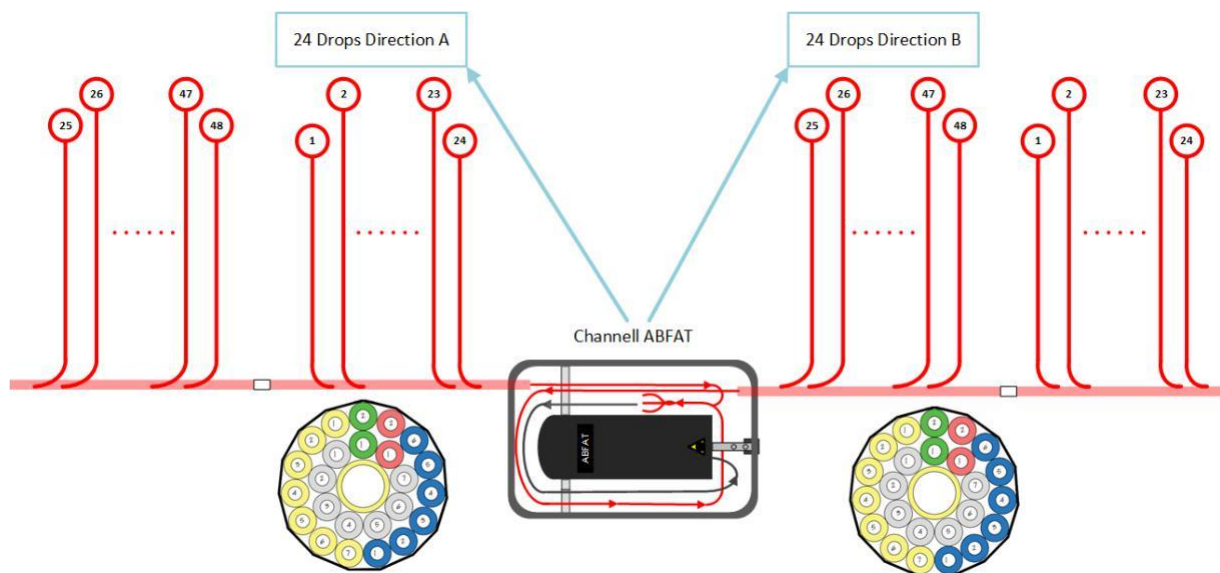

This solution has also been used to provide a LAYER 0/1 FTTH Wholesale solutions to meeting the requirements of a “dig once” principle mandated by municipalities and governments. The Channel solution provides open access to the customer premises with the wholesale operator able to run their own feeder/distribution fibre, without additional civil work requirements. Channel can provide FTTH architecture design assistance, assisted in site design, and provided training were required.

PRODUCT CODES - CHANNELL Integrated Fibre solution - FLASH9

Product Code	Description
TBA	TBA

9 Fibre Hub Products

The Optimus Fibre Hub Cabinet products (OAFH & OCFH) are part of the Fibre Hub series of closures Which are free breathing aluminium constructed fibre cabinets for traditional FTTH network architectures.



Each Optimus Fibre Hub Cabinet supports cartridge type splitter, fibre connector fields, active tail parking bays for the rapid connection of FTTH customer in a pre-fibred FTTH network.

The Optimus Fibre Hub Cabinet products can also be deployed with the G9 Fibre Hub closures as part of a unified pre-fibred architecture, that simplifies the provisioning process and reduces the operational costs of customer connections

The Optimus Fibre Hub Cabinet is a powder coated aluminium cabinet designed for centralized split points in a PON network. The 72, 96, 144, and 288 fibre termination choices allow operators to scale the cabinet cost to their network design.

The Optimus Fibre Hub Cross Connect Cabinet exists in 2 versions

- OAFH Cross Connect pole/wall mounted Optimus Cabinet Fibre Hub
- OCFH Cross Connect Vault / Pad mounted Optimus Cabinet Fibre Hub

Key Features & Benefits

- Fibre Bend Radius Protection provides timeless performance.
- Intuitive fibre routing provides ease of use and repeatable splitter installation.
- Easy connector access allows easy cleaning access and quick reliable connections.
- Diverse splitter, WDM/Splitter, and CWDM module choice allow deployment in all GPON, EPON, and RFOG deployments as well in both centralized split and decentralized split network configurations.
- Splitter module fits all styles of Fibre Hub enclosures; which minimizes inventory and guarantees that the technician has the right modules to complete the work order.

- Splitter Modules include 1X32, 2x32, 1X16, 2X16, Dual 1X16, 1X8, Quad 1X8, 1X4, Sextuple 1X4, 1X2, and many versions of CWDM and DWDM multiplexer modules.
- Splitter Modules exceed GR-1209 and GR-1221 optical requirements and connect with GR-326 connectors delivering superb optical performance.
- Cabinets are Pole, Wall, and H-Frame mountable giving them placement flexibility
- Cabinets are manufactured with corrosion resistant 5052 H32 high strength aluminium with welded seams and a powder coated finish will deliver decades of cabinet life.
- Powder coated, welded and gasketed Cabinets deliver NEMA 4 watertight and dust tight performance.

9.1 Optimus Pole / Wall mount Cross Connect Cabinet

The OCFH Cross Connect pole/wall mounted Optimus Cabinet Fibre Hub



Dimensions / Capacity

OAFH Cross Connect pole/wall mounted Optimus Cabinet Fibre Hub

Distribution Count	Cabinet Dimensions (mm)	Rec Feed Count	Splitter Module Capacity	Rec Stub Length	Rec Stub Entry
72, 96, 144	380w x 710H x 305D	12F - 24F	8	30M	Rear Entry Stub Up
288	546w x 788H x 330D	24F - 36F	15	30M	Rear Entry Stub Up

PRODUCT CODES - CHANNELL Fibre Hub solution (EXAMPLES)

Product Code	Description
OAFH144ABAPBDU2A	OPTIMUS POLE/M FH 144F DIST C/F SC/APC, 24F FEEDER, 1x 1:32 SPLITTER, 30M STUB, ADSS, BACK ENTRY UP, BEIGE, HEX HEAD + PADLOCK
OAFH144ABAWBDB2C	OPTIMUS WALL/M FH 144F DIST C/F SC/APC, 24F FEEDER, 1x 1:32 SPLITTER, 30M STUB, ADSS, BOTTOM ENTRY, BEIGE, LB1 ENTRY + PADLOCK
OAFH288XDEWCAB2C	OPTIMUS WALL/M FH 288F DIST C/F SC/APC & MTP, 48F FEEDER, 5x 1:32 SPLITTER, 60M STUB, ARMORED L/TUBE, BOTTOM ENTRY, BEIGE, LB1 ENTRY + PADLOCK

9.2 Optimus Vault / Pad mount Cross Connect Cabinet

The OCFH Cross Connect Vault / Pad mounted Optimus Cabinet Fibre Hub



Dimensions / Capacity

OCFH Cross Connect vault/pad mounted Optimus Cabinet Fibre Hub

Distribution Count	Cabinet Dimensions (mm)	Rec Feed Count	Splitter Module Capacity	Rec Stub Length	Rec Stub Entry
72, 96, 144	380w x 710H x 305D	12F - 24F	8	30M	Rear Entry Stub Down
288	546w x 788H x 330D	24F - 36F	15	30M	Rear Entry Stub Down

PRODUCT CODES - CHANNELL Fibre Hub solution (EXAMPLES)

Product Code	Description
OCFH144ABANBDD2A	OPTIMUS CABINET 144F DIST C/F SC/APC, 24F FEEDER, 1x 1:32 SPLITTER, 30M STUB, ADSS, BOTTOM ENTRY, BEIGE, HEX HEAD + PADLOCK
OCFH144ABANCBDD2C	OPTIMUS CABINET 144F DIST C/F SC/APC, 24F FEEDER, 1x 1:32 SPLITTER, 30M STUB, ADSS, BOTTOM ENTRY, BEIGE, LB1 ENTRY + PADLOCK
OCFH288XDENCAD2C	OPTIMUS CABINET 288F DIST C/F SC/APC & MTP, 48F FEEDER, 5x 1:32 SPLITTER, 60M STUB, ARMORED L/TUBE, BOTTOM ENTRY, BEIGE, LB1 ENTRY + PADLOCK

10 Pedestal Products

Channell pedestals are part of the Optimus Family of free breathing products and are designed specifically for housing passive equipment, with the larger pedestals housing rigidized active equipment.



Made from HDPE, these pedestals feature direct-bury bases with a high rib design that do not require stakes for installation. The direct-bury pedestal bases result in a more uniform and secure installation and are less likely to lean or tilt.

A special self-locating cover security feature ensures that the pedestals lock properly without requiring special alignment. The covers utilize Channell's proven Self-Lock® security hardware and tools used on all installed pedestals.

10.1 Pedestal Products - Generic

The CHANNELL Pedestal family are a series of multipurpose pedestals of various sizes and shapes, used by operators for copper cable termination, COAX or XDSL networks, and supports small fibre closures for FTTH applications. There is generally a closure size that fits any application required by a customer.

ROUND Pedestals



Dimensions

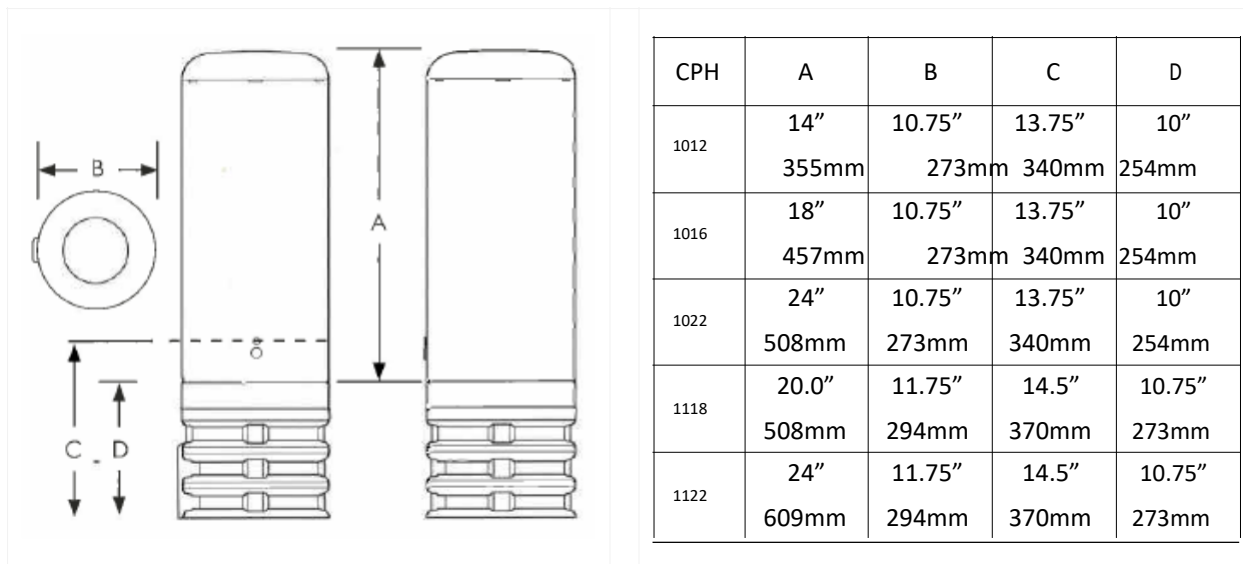

The Square and Rectangular pedestals are larger and offer more workable space than the round pedestals.

SQUARE & RECTANGULAR pedestals



Features of these pedestals are:

- Complete 360 degree working access
- Non-corrosive, lightweight, and rugged
- Constructed of high-performance thermoplastic materials
- Universal mounting plate available
- Self-locking lock mechanism
- Optional security lock head designs
- Designed to the requirements of Telcordia Spec GR-13-Core
- High rib base for stable mounting

Dimensions

Multiple Access Housing	COVER	BASE
MAH10103	336mm x 317mm x 457mm	368mm x 317mm x 381mm
MAH10106	336mm x 317mm x 660mm	368mm x 317mm x 381mm

MAH1212	305mm x 305mm x 813mm	305mm x 305mm x 381mm
MAH1420	356mm x 508mm x 914mm	356mm x 508mm x 381mm

The SPH series pedestals have been designed as a Broadband active equipment enclosure, supporting ruggedised active equipment for COAX or XDSL networks.



SPH1230 Base



SLGLB1230 Base

Signature Pedestal Housing	COVER	BASE
SPH1230	305mm x 762mm x 813mm	SGLB1230 base or SPH1230 base

PRODUCT CODES - CHANNELL Pedestal closures

Product Code	Description
CPH1012	
CPH1016	
CPH1022	
CPH1118	
CPH1122	

PRODUCT CODES - CHANNELL Pedestal closures

Product Code	Description
MAH10103	
MAH10106	
MAH1212	
MAH1420	
SPH101003	
SPH121223	
SPH1230	

PRODUCT CODES - CHANNELL Pedestal closures

Product Code	Description
SPH101003	
SPH121223	
SPH1230	

10.2 Pedestal Optimus Fibre Products

Channell pedestals are part of the Optimus Family of free breathing products and are designed specifically for housing passive equipment, with the larger pedestals housing rigidized active equipment



The Optimus Pedestal is the industry standard in Fibre free-breathing Pedestal Enclosures and are available in a wide range of sizes and configurations. They are constructed of rugged, high-performance thermoplastic material and designed to be craft friendly.

10.2.1 Fibre Pedestals for Air Blown Fibre Applications - OR912 Series

The OR series pedestals are specifically designed for Blown Fibre applications within a FTTX networks. Based on the Challenger Pedestal Housing series they feature direct-bury bases with a high rib design for a secure installation that is less likely to lean or tilt.

The OR series pedestals include a hinged, stackable, and removable fibre splice trays, as well as a slack tube storage bay for uncut tube and fibre to be looped, organized, and stored

9 Inch Blown Fibre Pedestal:

Features

- Tray Capacity: 6 Tray
- Splice Capacity: 96 splices single stack
- Drop Comb: 32x 7 / 3.5 mm drop micro-ducts
- Main Comb: 3x 14mm micro-ducts
- Security: Channell Self Lock

Dimensions

- Above Ground Height = 712 mm
- Below Ground depth = 265 mm
- Cover Length = 610 mm
- Base Diameter = 240 mm



10.2.2 Fibre Pedestals for Air Blown Fibre Applications - OR414 Series

The OR series pedestals are Optimus free breathing enclosures specifically designed for Blown Fibre applications within a FTTX networks. Based on the Challenger Pedestal Housing series they feature direct-bury bases with a high rib design for a secure installation that is less likely to lean or tilt.

The OR414 is a small 12f drop pedestal support 6x drop micro ducts and 12 splices



4 Inch Blown Fibre Pedestal:

Features

- Tray Capacity: 1 Tray
- Splice Capacity: 12 splices single stack / 24 splices double stacked
- Drop Comb: 6x 7 / 3.5 mm drop micro-ducts
- Security: Channell Self Lock

Dimensions

- Above Ground Height = 450 mm
- Below Ground depth = 216 mm
- Cover Length = 355 mm
- Base Diameter = 120.5 mm

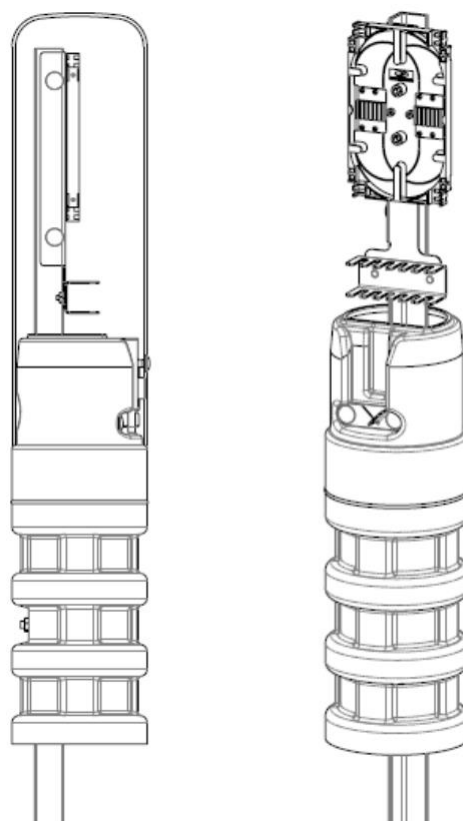

PRODUCT CODES - CHANNELL OPTIUMS Pedestal closures

Product Code	Description
OR9160001208	OPTIMUS R9 SERIES SPECIAL
OR414160001376	OPTIMUS 400-SERIES SPECIAL

10.2.3 Fibre Pedestals for Active Equipment Applications - OP1230 series

The Optimus Pedestal (OP) series are free breathing enclosures specifically designed for Fibre applications including ruggedised Active Fibre / DSL Equipment within a FTTC networks.

OP1230 Pedestal:

Features

- Supports
 - Power Unit
 - FIBRE to VDSL2 Node
 - Fibre Splice closure
 - Copper Distribution Frame
 - Power Unit
 - Backup Batteries
- Security: Channell Self Lock
- BULK1230 Pit Base

Dimensions

- Above Ground Height = 810 mm
- Below Ground depth = 610 mm
- Pedestal Length = 645mm
- Pedestal Width = 420mm



PRODUCT CODES - CHANNELL OPTIUMS Pedestal closures

Product Code	Description
OP12302160001670	OPTIMUS SPECIAL, 12302 FIBER VAULT

10.3 Integrated Optimus Fibre Pedestal

The Integrated Optimus Pedestal (OP) series are free breathing fibre enclosures that have been integrated into a BULK series Vaults, greatly increasing the workable space below ground, for fibre slack loops, branching closures and additional underground network assets.

The fibre closure is constructed of rugged, high-performance thermoplastic material and designed to be craft friendly.

The BULK Pits are constructed from HDPE with a Split HDPE cover set. One side of the HDPE cover set supports the pedestal frame and allows the pedestal cover to be seated into the HDPE vault cover. The second half of the HDPE Vault cover can be removed for access into the vault.

The pedestal covers are essentially derived from the MAH pedestal series and support the following sizes.

	Cover Size
MAH10103	13.25" x 12.5" x 18.0" 336mm x 317mm x 457mm
MAH10106	13.25" x 12.5" x 26.0" 336mm x 317mm x 660mm



PRODUCT CODES - CHANNELL OPTIUMS Pedestal closures

Product Code	Description
TBA	TBA

10.4 Integrated Flash Fibre Pedestal

The Channell FLASH series products, sees the integration of the Channell environmentally sealed closures (Green Hornet Series) and the BULK series Vaults to deliver a Pedestal solution that provided maximum asset protection for critical fibre networks.



The FLASH 9 is a 9" diameter environmentally sealed dome closure with the following features

Features

- Environmentally sealed: air/watertight (weatherproof and flood proof) meets test standards of GR771, GR13, & IP68
- Capacity: 6x 24f splice Trays (Hinged)
- Splice Capacity: 144 splices single stack
- Separate Fibre Management Bay
- SC/APC connector field 8-unit / 16-unit simplex
- LC/APC connector field 8-unit / 16-unit duplex

- Colour Options (Light Green, Beige, Dark Green)
- Port Capacity:
 - 1 main oval port (10.16 – 30.48 mm)
 - 16 drop ports (5.08 – 12.7mm)
 - 2 branch ports (10.16 – 22.86 mm)
 - 1 ground port
- Security: Channell Security lock

Dimensions

- Flash 9 Diameter = 229mm
- Above Ground Height = 508 mm
- Below Ground depth = Typically 610mm (BULK3 depth)

PRODUCT CODES - CHANNELL FLASH Pedestal closures

Product Code	Description
F9L20S1F2C1G0A02	CHANNELL FLASH9, 48f, LIGHT GREEN, NO GROUND, SC/APC 16 UNIT
F9L20S1F2C1G0A05	CHANNELL FLASH9, 48f, LIGHT GREEN, NO GROUND, LC/APC 16 UNIT
F9L20S1F6C1G0A00	CHANNELL FLASH9, 144f, LIGHT GREEN, NO GROUND, NO ACCESSORIES

Note: 144f configuration does not support accessories (connector field)

Accessories

Product Code	Description
GR03116213	Main Oval Port Grommet (12 Pack) / 0.4-1.2 inches (10.16-30.48 mm)
GR16000672	Branch Grommet (12 Pack) / 0.4-0.9 inches (10.16-22.86 mm)
GR03116101-34/ GR06116101-34	Drop Port Grommet (3 or 12 Pack) / 0.188-0.250 inches (4.78-6.35 mm)
GR03116101-45/ GR06116101-45	Drop Port Grommet (3 or 12 Pack) / 0.250-0.312 inches (6.35-7.92 mm)
GR03116101-56/ GR06116101-56	Drop Port Grommet (3 or 12 Pack) / 0.312-0.375 inches (7.92-9.53 mm)
GR03116101-67/ GR06116101-67	Drop Port Grommet (3 or 12 Pack) / 0.375-0.438 inches (9.53-11.13 mm)
GR03116101-78/ GR06116101-78	Drop Port Grommet (3 or 12 Pack) / 0.438-0.500 inches (9.53-12.7 mm)
GR03116101-89/ GR06116101-89	Drop Port Grommet (3 or 12 Pack) / 0.500-0.562 inches (12.7-14.27 mm)
GR2106101-1250	Ground Bar Slotted Grommet (12 Pack)
CAS00566	Fiber Splice Tray without Protective Cover
CAS00567	Fiber Splice Tray with Protective Cover
BR03018090	Primary Mounting Bracket
GB06018093	Ground Bar Kit for External Ground

11 Cabinet Products

The CHANNELL Cabinet Series is a range of active roadside equipment cabinets designed for the Mobile operator 4G / 5G deployments, and municipalities traffic signal control cabinet.

11.1 Integrated Cabinet

Example of Integrated vented cabinet designed below used for 4G / 5G deployments



PRODUCT CODES - CHANNELL integrated Cabinets

Product Code	Description
TBA	TBA
TBA	TBA
TBA	TBA

12 Cabinet Security Locks

The claw is a heavy-duty tamper-resistant, recessed, security strap designed to protect and lock MDU Wall Boxes that are currently in service.

The claw guards MDU Boxes against continual vandalism and theft; it is quick and easy to install in the field on most brands of MDU Box. The claw allows you to lock Boxes on site that are damaged, broken, or no longer secure, without interruption of service

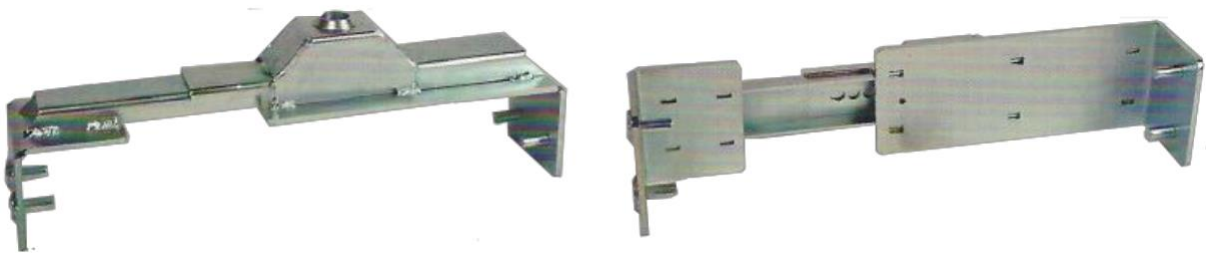

Features

- Rugged all steel construction
- RoHS blue zinc chromate electroplated
- Fits most brands of MDU boxes
- One-piece unit is easy to install with a step drill, no hardware required
- Available in two sizes to accommodate boxes ranging in widths
 - 305mm – 406mm
 - 457mm – 610mm
- Multiple Patten Locks available

